

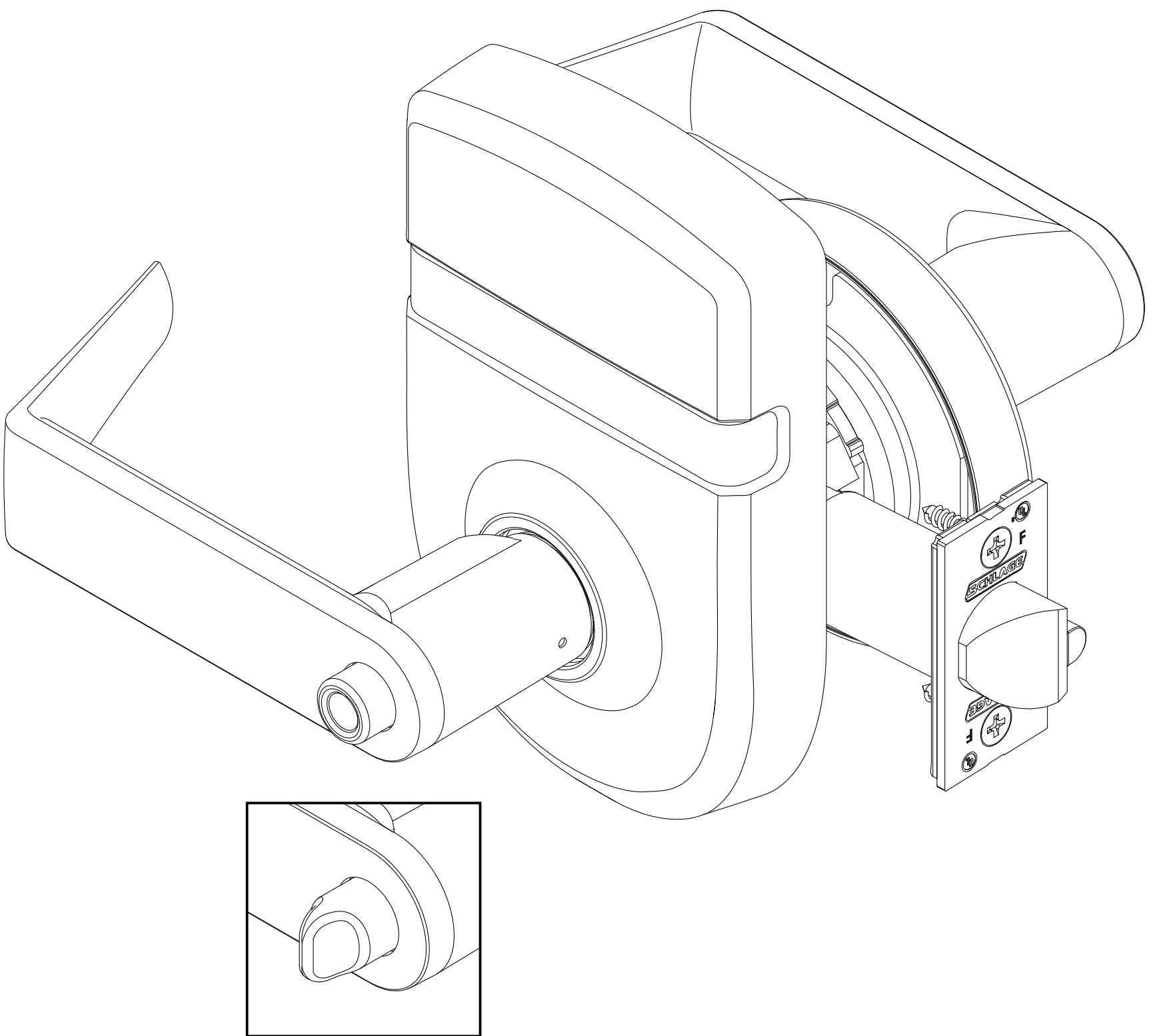

ND50/53-Series

Installation Instructions



Part Identification

Inside Handle

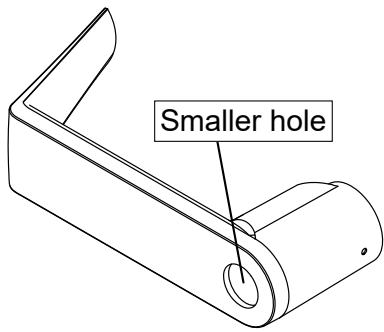

Inside Spring Cage

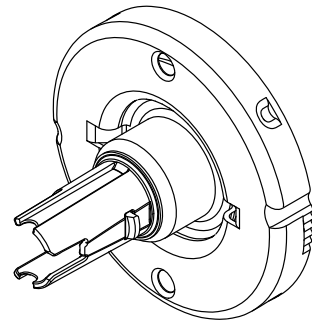

Outside Handle

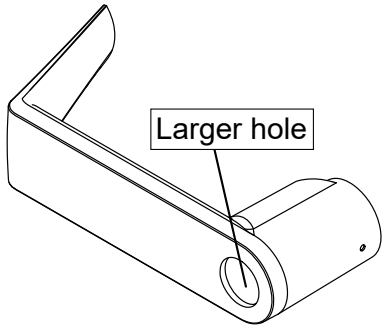

Outside Spring Cage

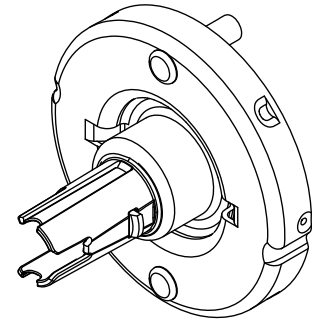

Anti-Rotation Plate

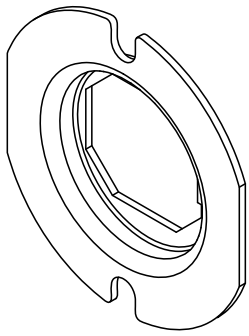

Chassis

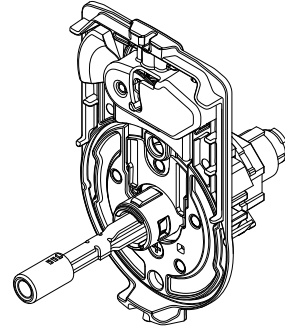

Indicator Sign

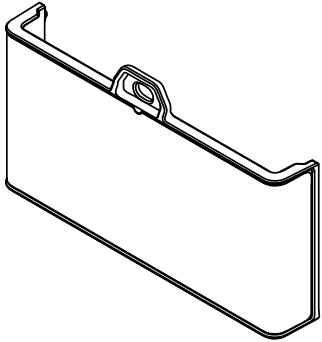

Rose

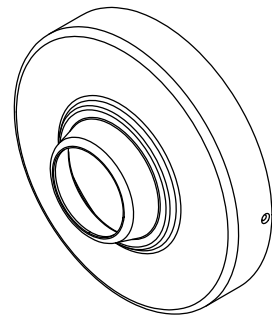

Escutcheon

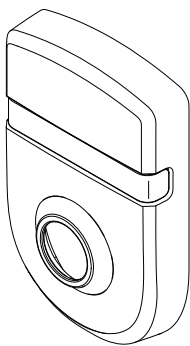

Latch

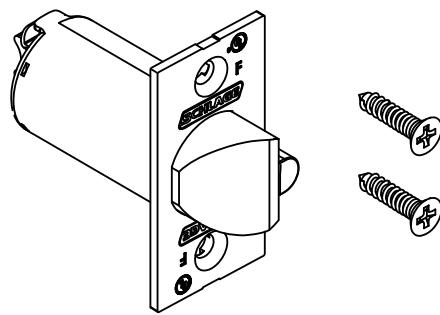

Mounting Screws

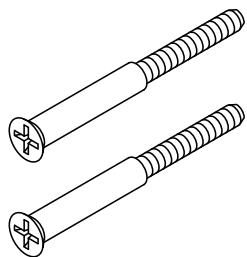

Strike Plate

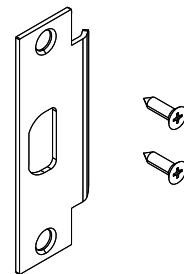

Key Cylinders

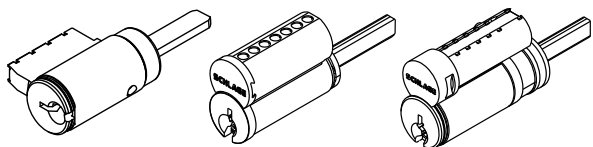

Hex Wrench & Escutcheon Set Screw

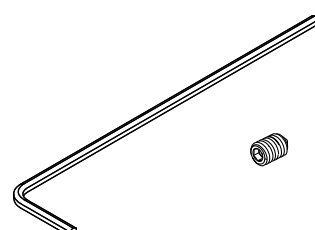

Installation Preparation

Door preparation:

For door preparation use the template included in the package with the lock. For additional information, visit the website www.allegion.com/us.

Tools for Install

Required:

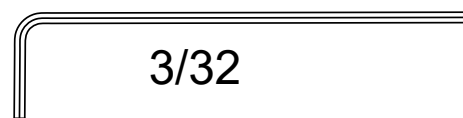
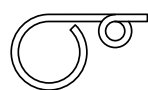
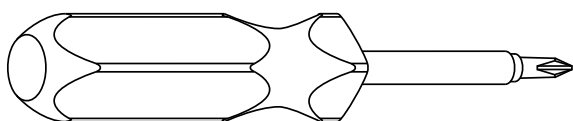

Optional:

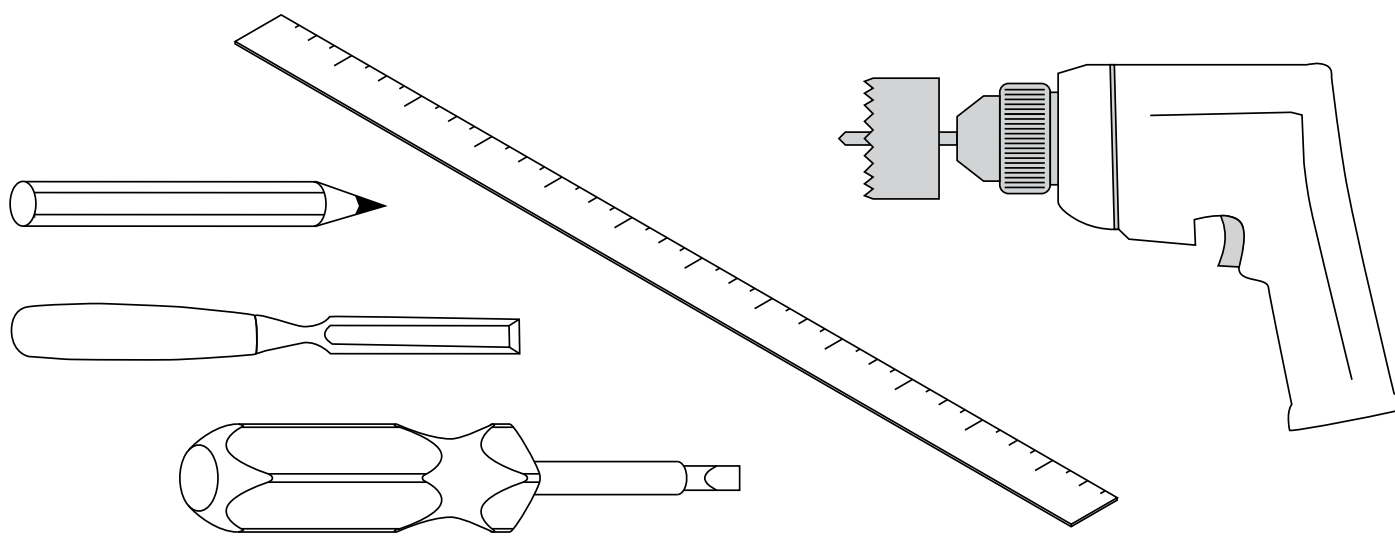

IMPORTANT – DOOR THICKNESS

This lock function is only compatible with 1-3/4" door thickness.

For thinner door applications, refer to these spacer kits:

| Door Thickness | PN |
|--|----------|
| 1 ³ / ₈ " TO 1 ¹ / ₂ " | 48029970 |
| 1 ¹ / ₂ " TO 1 ⁵ / ₈ " | 48029971 |
| 1 ⁵ / ₈ " TO 1 ¹¹ / ₁₆ " | 48029972 |

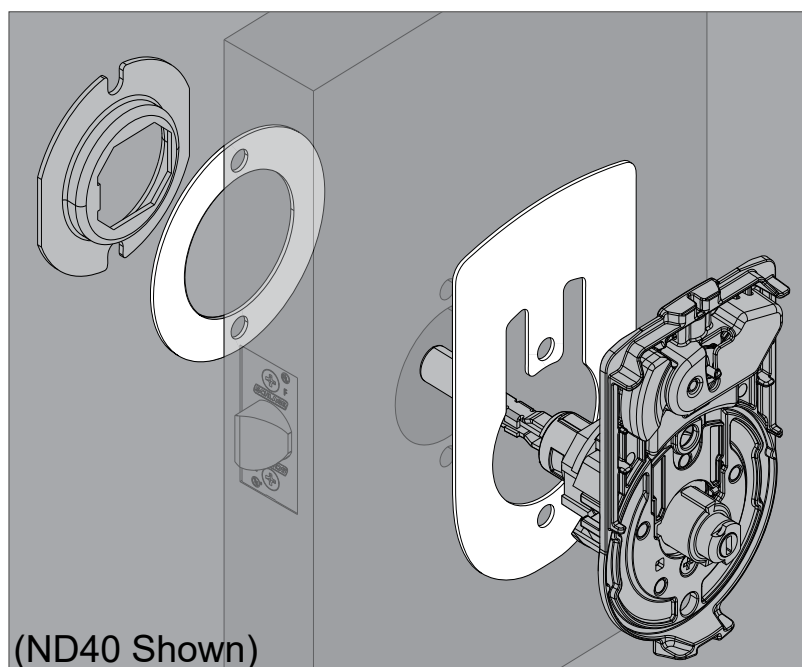

(ND40 Shown)

1 Install latch

The bevel must face toward the door stop. Tighten the two (2) screws.

ⓘ Note: For installation on unreinforced hollow metal doors, use of door spacer (part number 24483760) is recommended.

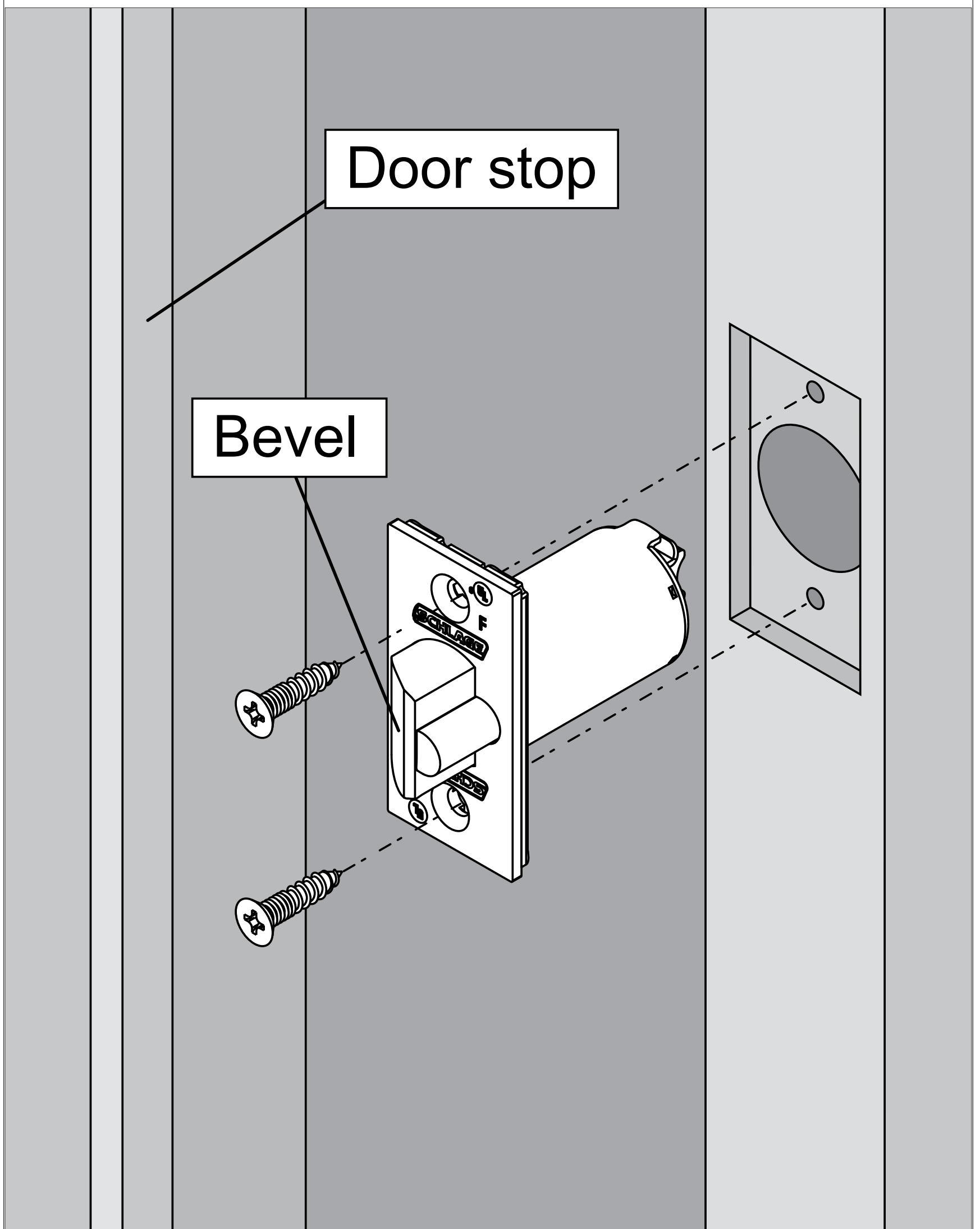

2 Install Indicator & Chassis

Install on **inside** of door with slide opening aligned towards latch. If slide opening does not align with latch, refer to **Chassis Handing**.

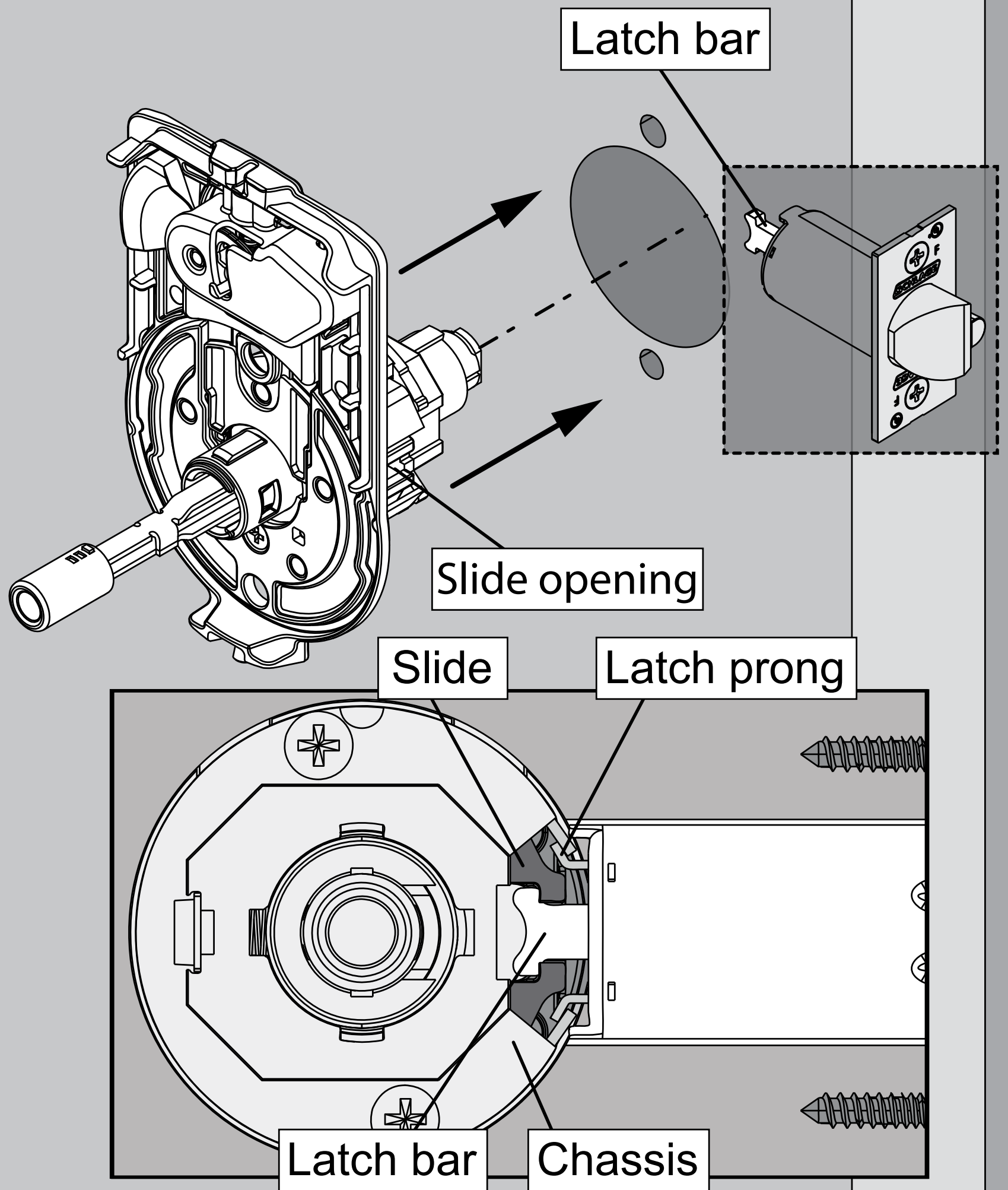

3 Install anti-rotation plate

Install on **outside** of door. Align the tab with the indent on the hub.

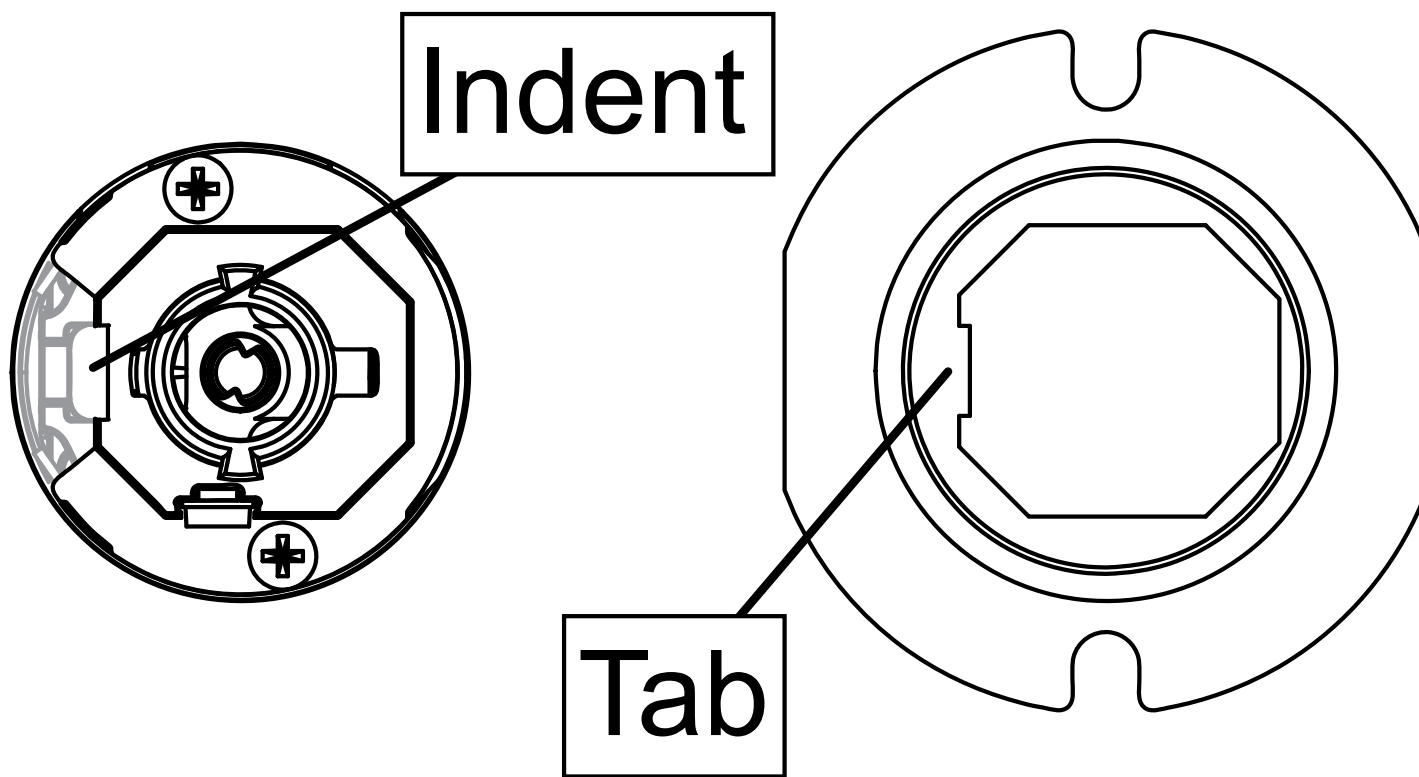
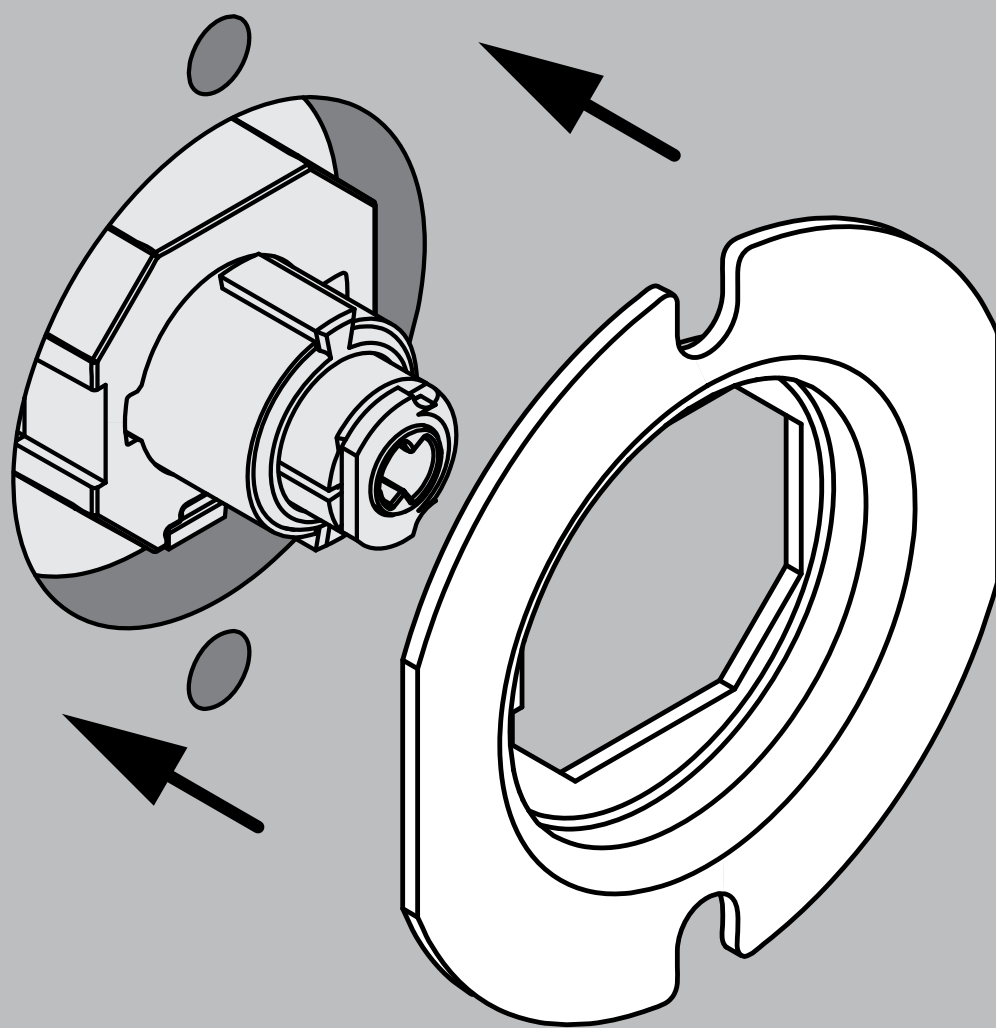
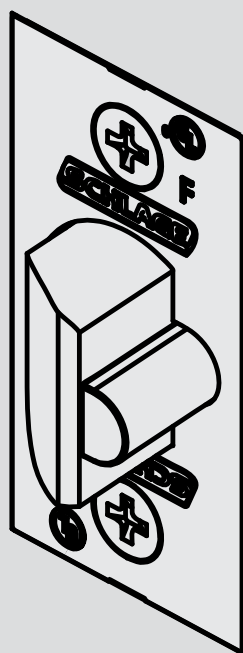

4 Assemble outside trim (1 of 2)

If not pre-assembled, snap the outside rose onto the outside spring cage and engage dimples.

Do *NOT* install IC Cylinders in this step.
Continue install without 4A, 4B, & 4D. Then continue to step 5.

- ① **Note that the outside spring cage is the one with the mounting posts.**

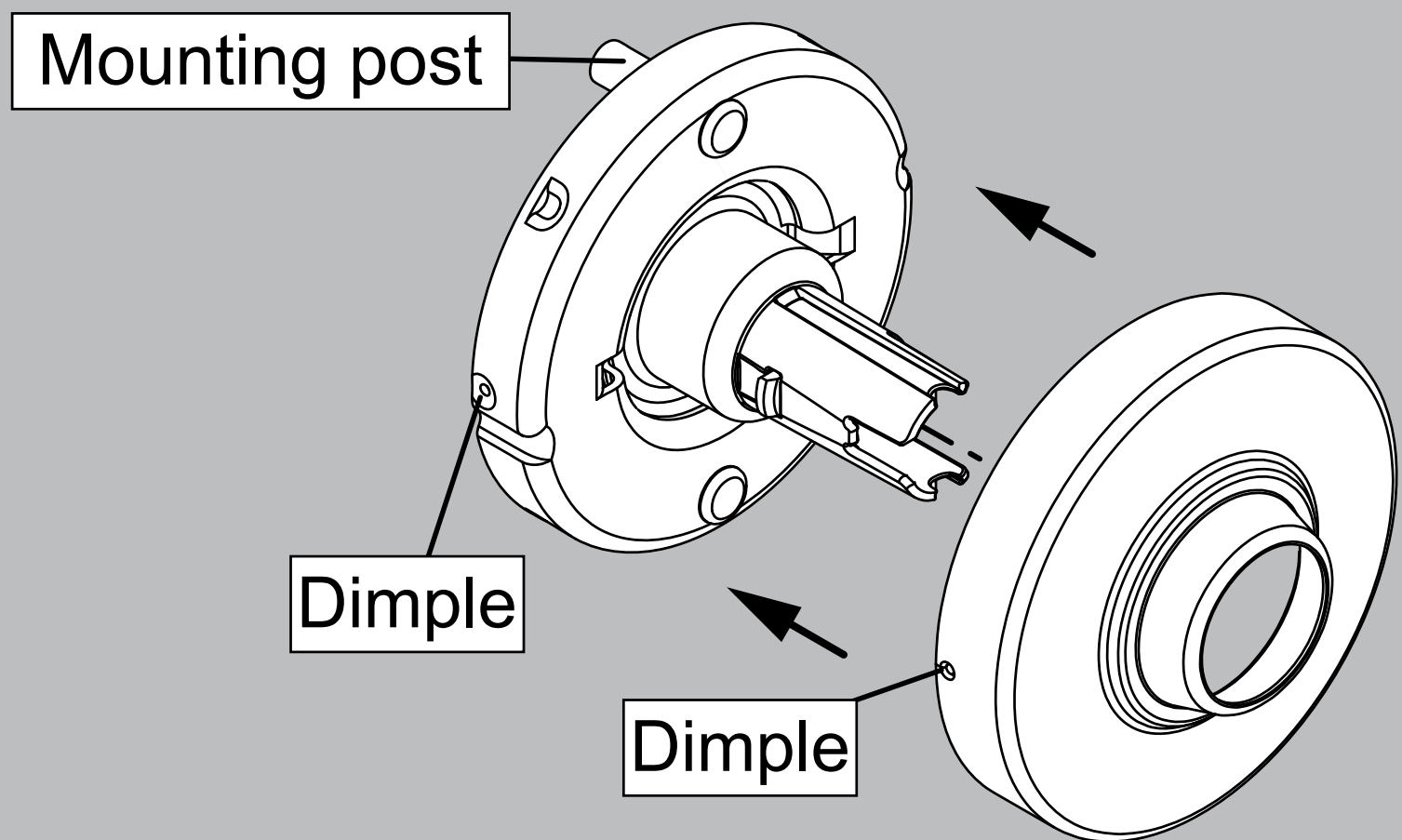

A. (KIL Cylinder Only) Place the cylinder assembly into the lever.

- ① **Note: The outside lever has a larger hole than the interior lever.**

B. (KIL Cylinder Only) Insert key and rotate 90° clockwise.

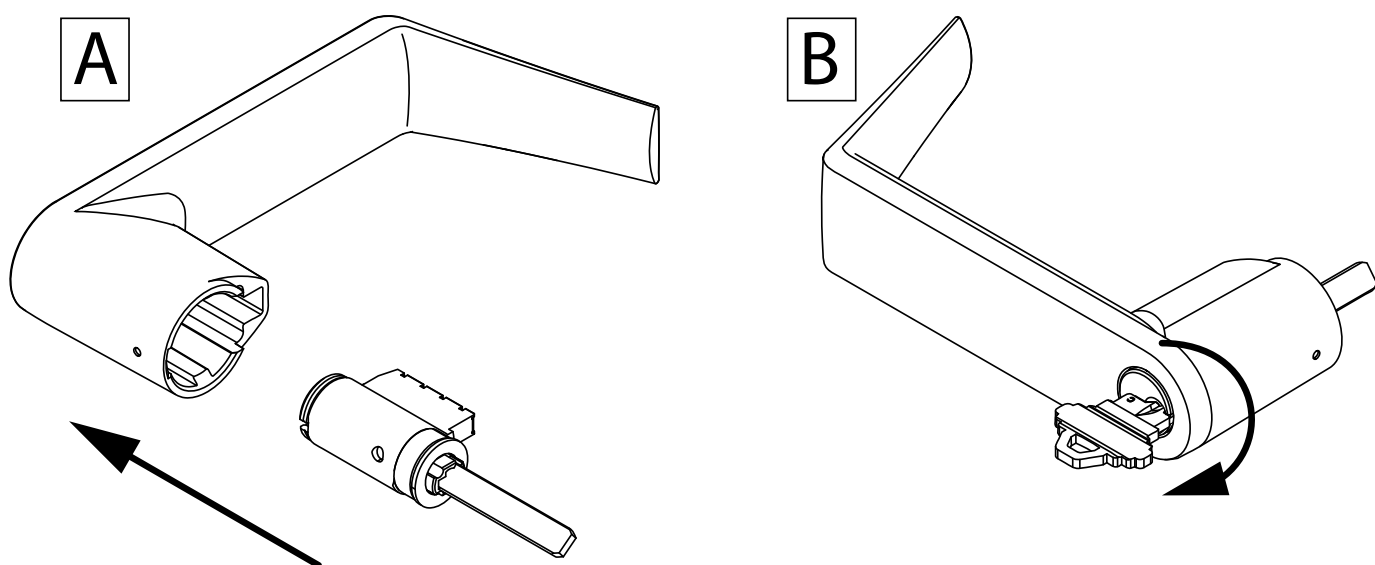

4 Assemble outside trim (2 of 2)

C. With key still rotated 90° clockwise, push outside lever onto the spindle.

Be sure to engage the lever catch. **For IC cylinders, install lever with lever catch.**

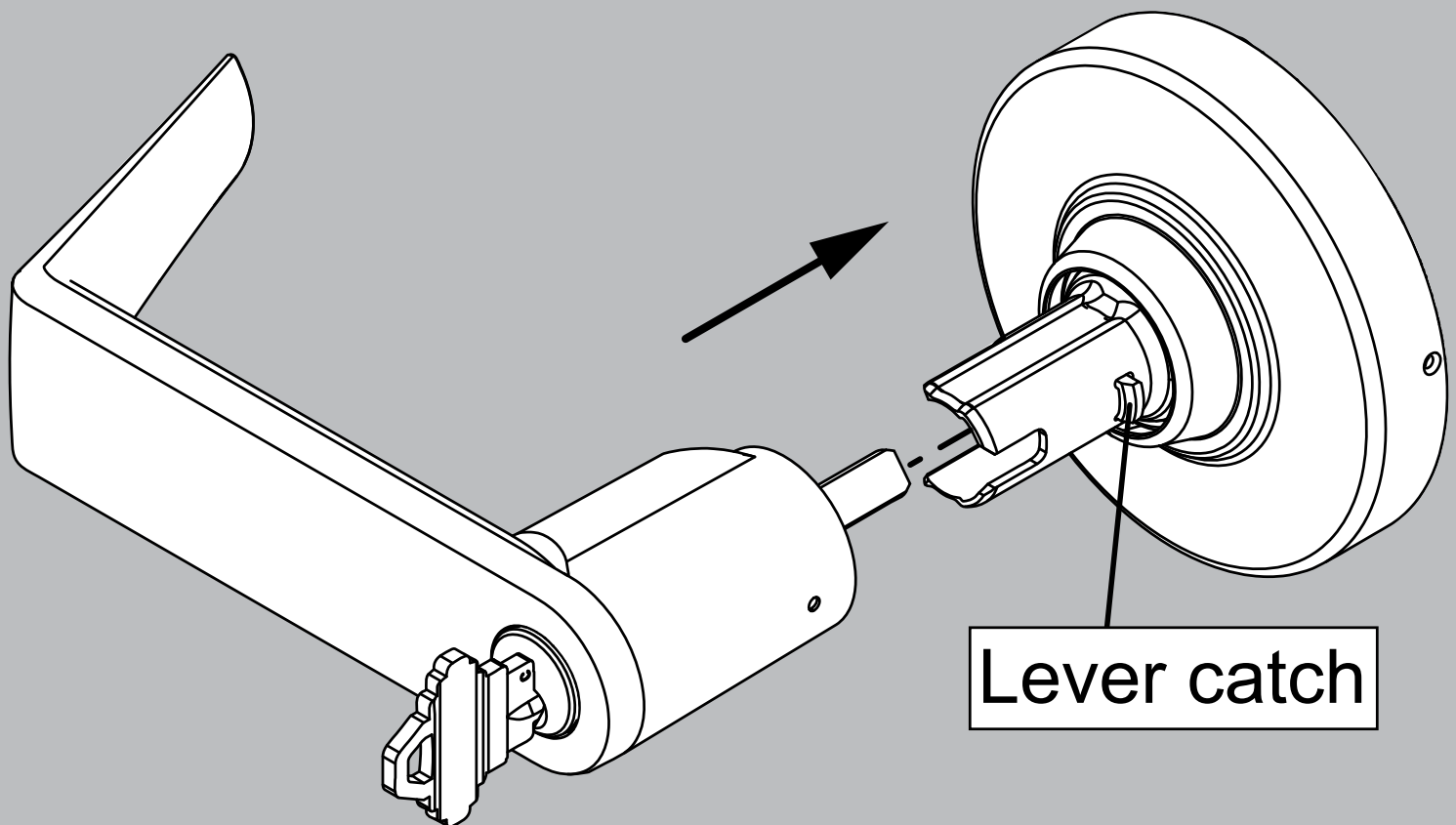

D. **(KIL Cylinder Only)** Rotate the key counterclockwise back to the starting position and remove the key.

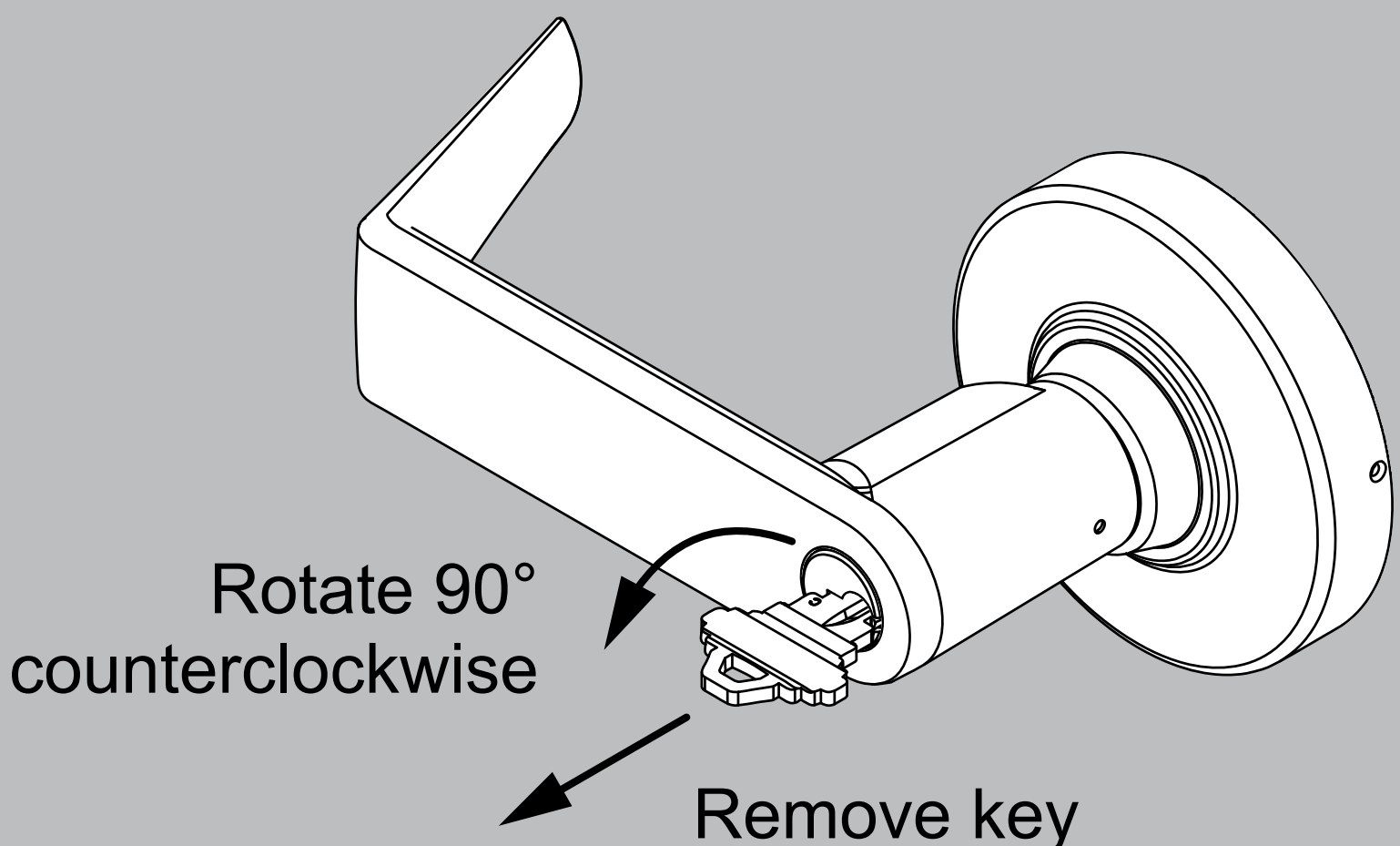

5 Adjust the cam position

Insert screwdriver into keycam and rotate **clockwise** until it stops.

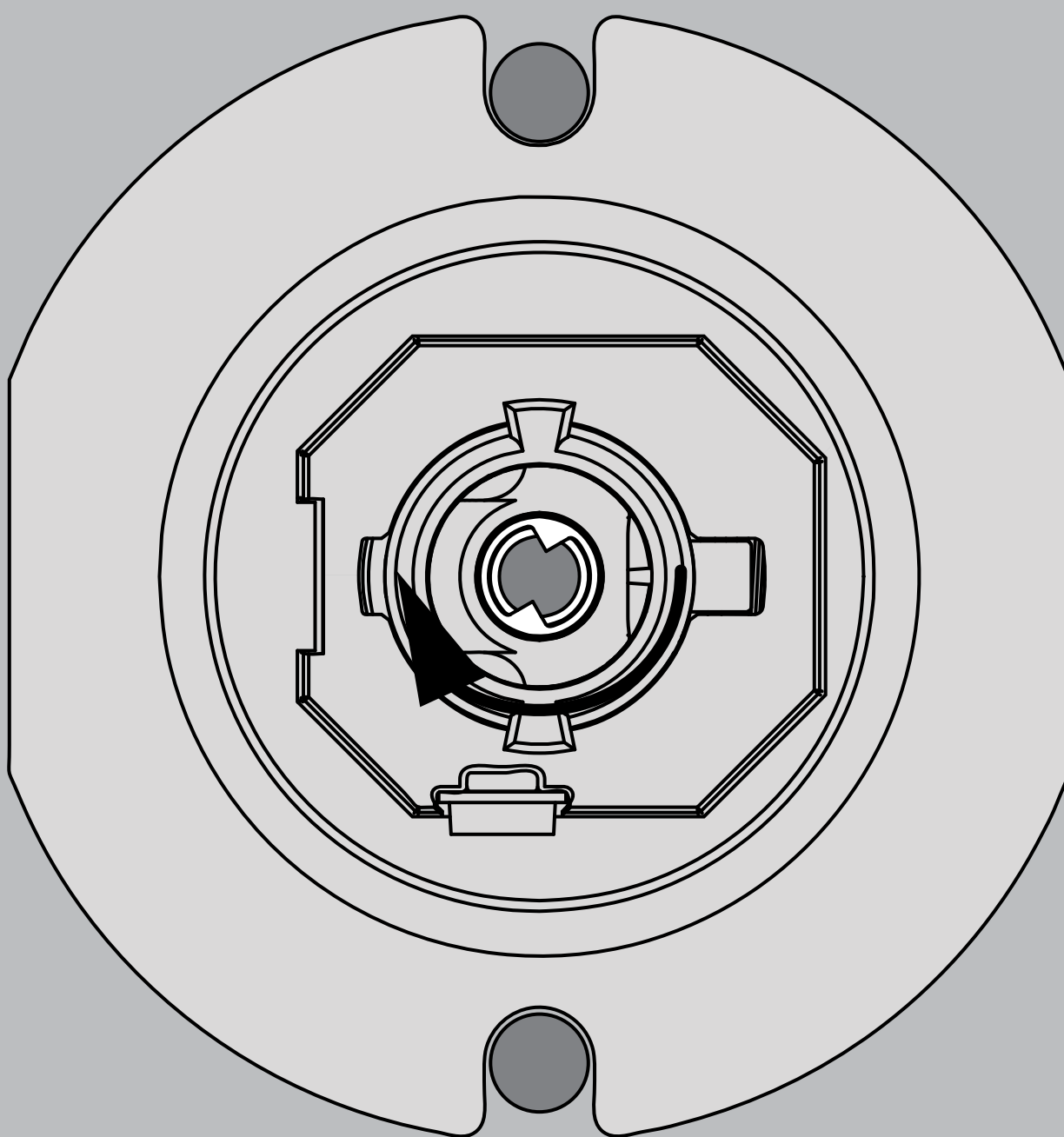
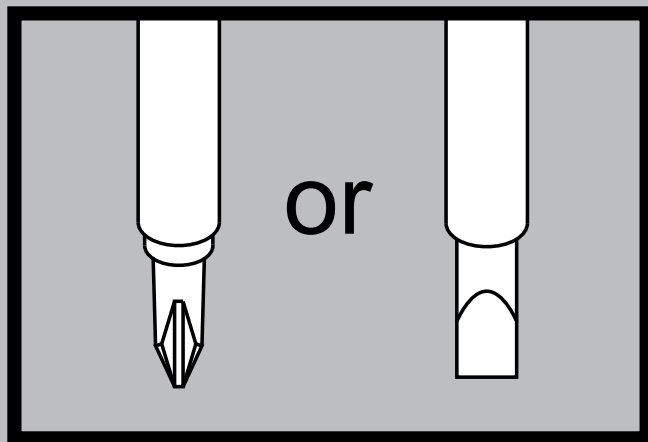

Correct cam position

6 Install outside trim

Install on **outside** of door.

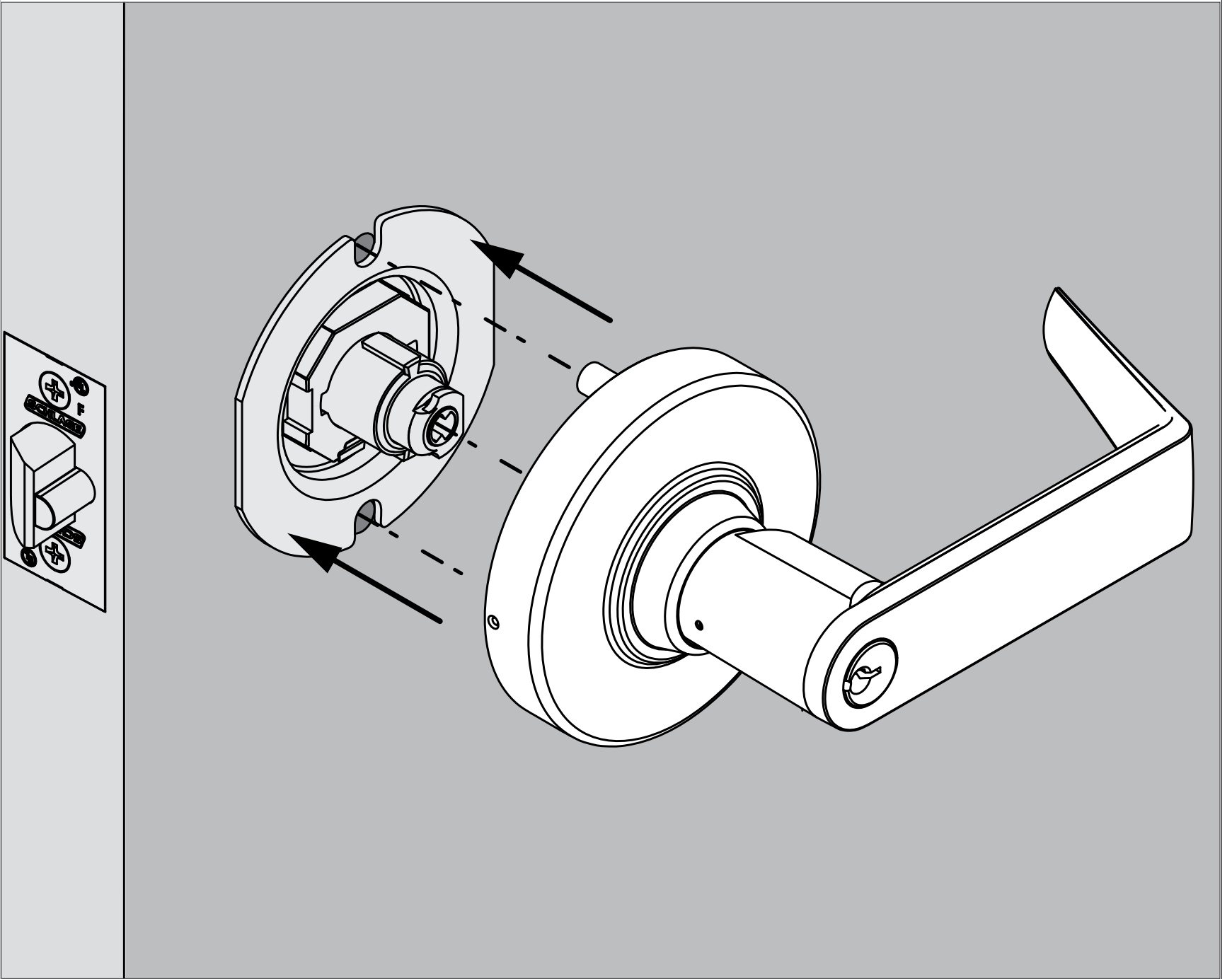

7 Install outside trim (IC Cylinder 1 of 2)

Insert IC cylinder tailpieces. Push in FSIC tailpiece until it snaps. (SFIC tailpiece does not snap)

FSIC cylinder:

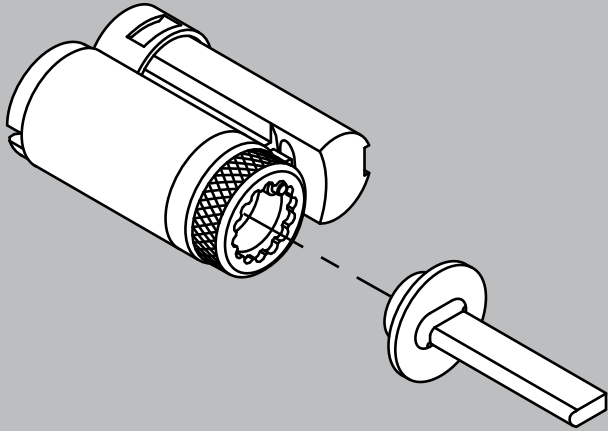

SFIC cylinder:

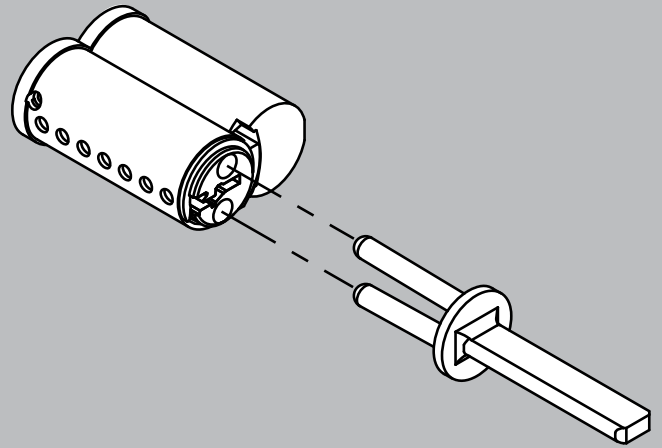

7 Install outside trim (IC Cylinder 2 of 2)

Insert the control key into the cylinder and rotate 15 degrees clockwise. Then insert the cylinder assembly into the lever.

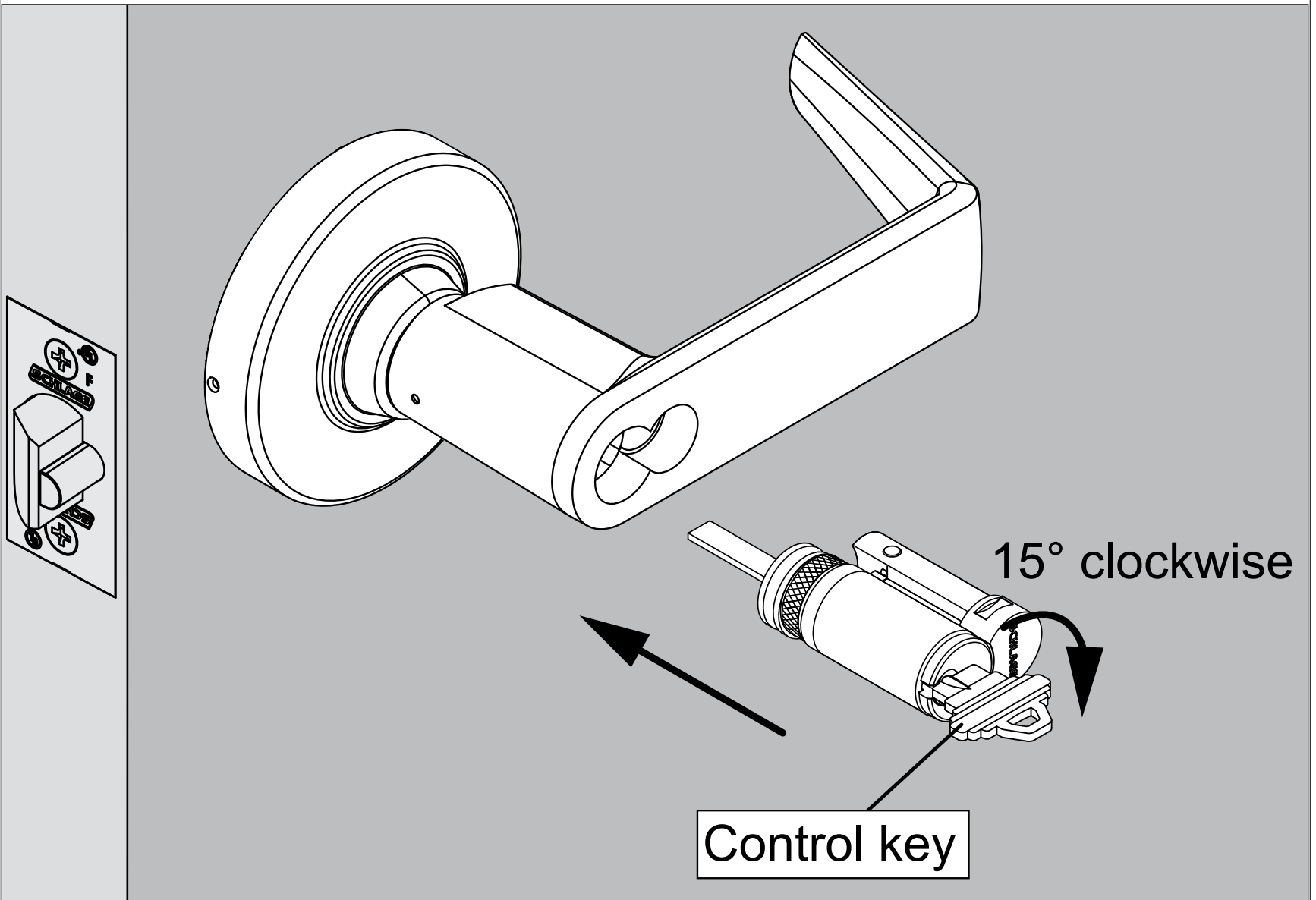

Rotate the key counterclockwise to starting position and remove it from the cylinder.

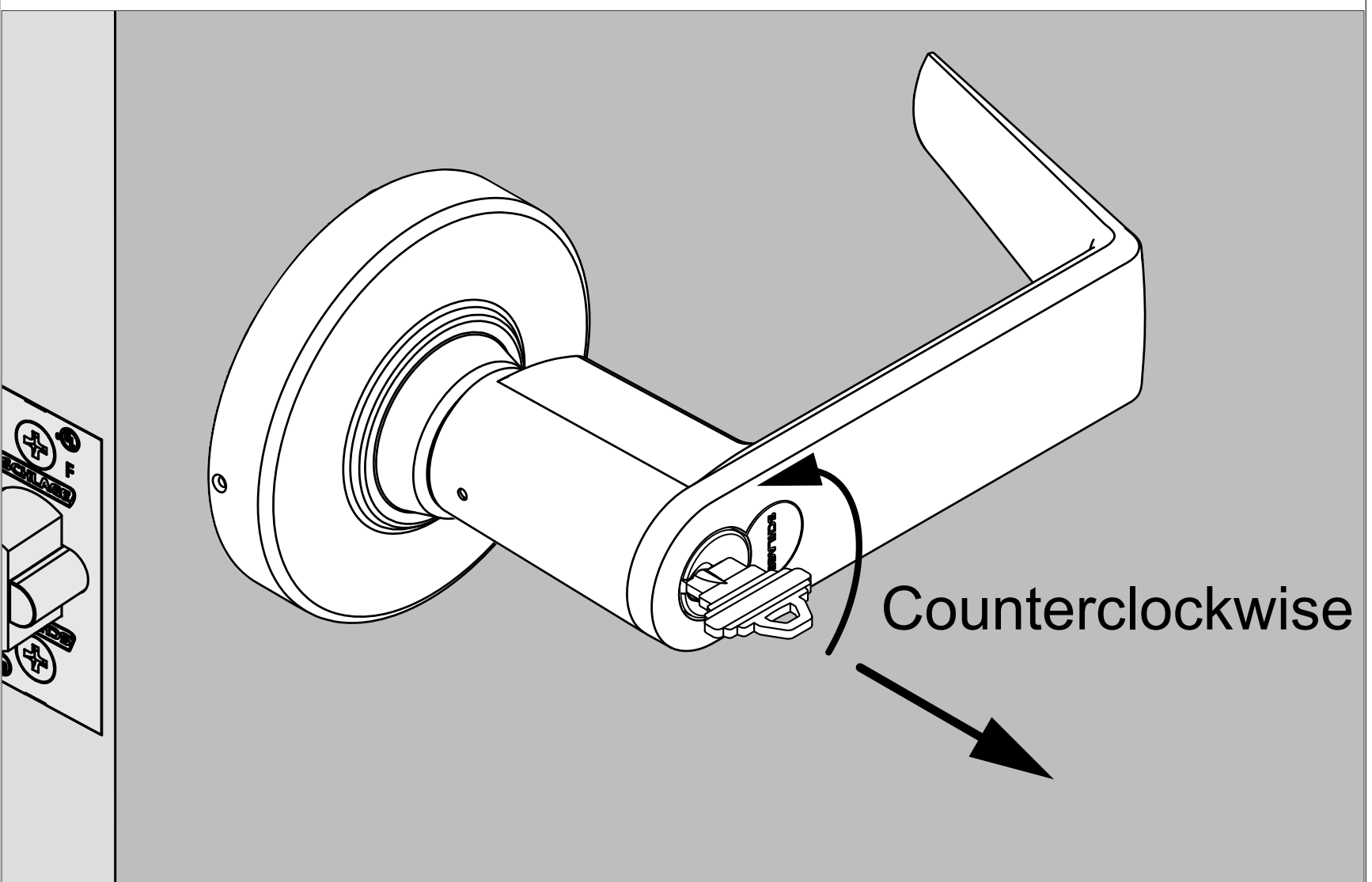

8 Install inside spring cage assembly

Lever catch faces door edge. Install and tighten mounting screws.

ⓘ Note: The inside spring cage has holes for screws.

WARNING

⚠ Do not overtighten the mounting screws.

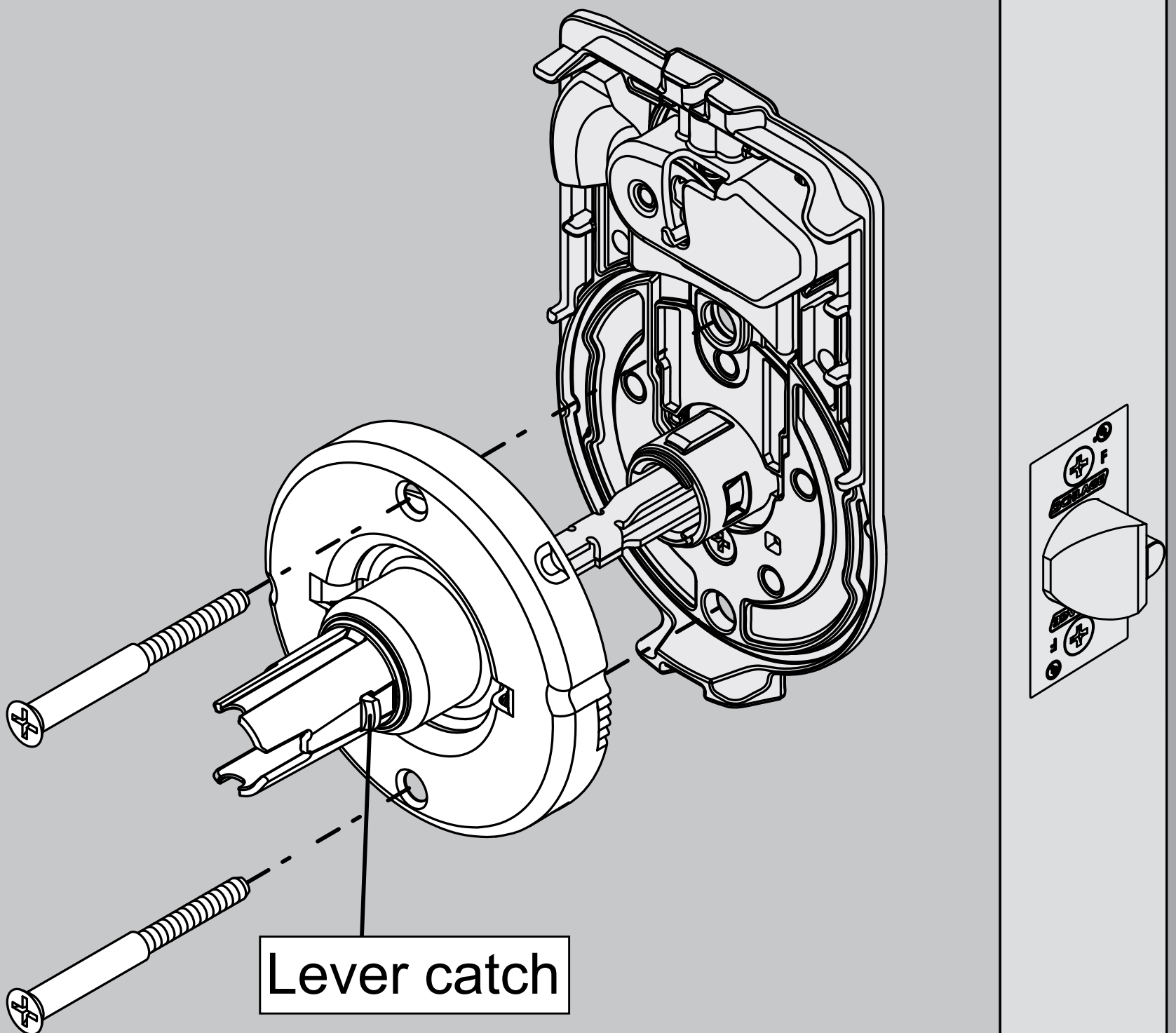

9 Install indicator sign

Place hole in indicator sign over hook on lever and confirm the sign is on housing ledges. Indicator sign will sit on top of the ledges.

Note: If there is trouble with sign staying on hook, push down on counterweight and hook will move upwards to assist with installation.

Counter-weight

Hook

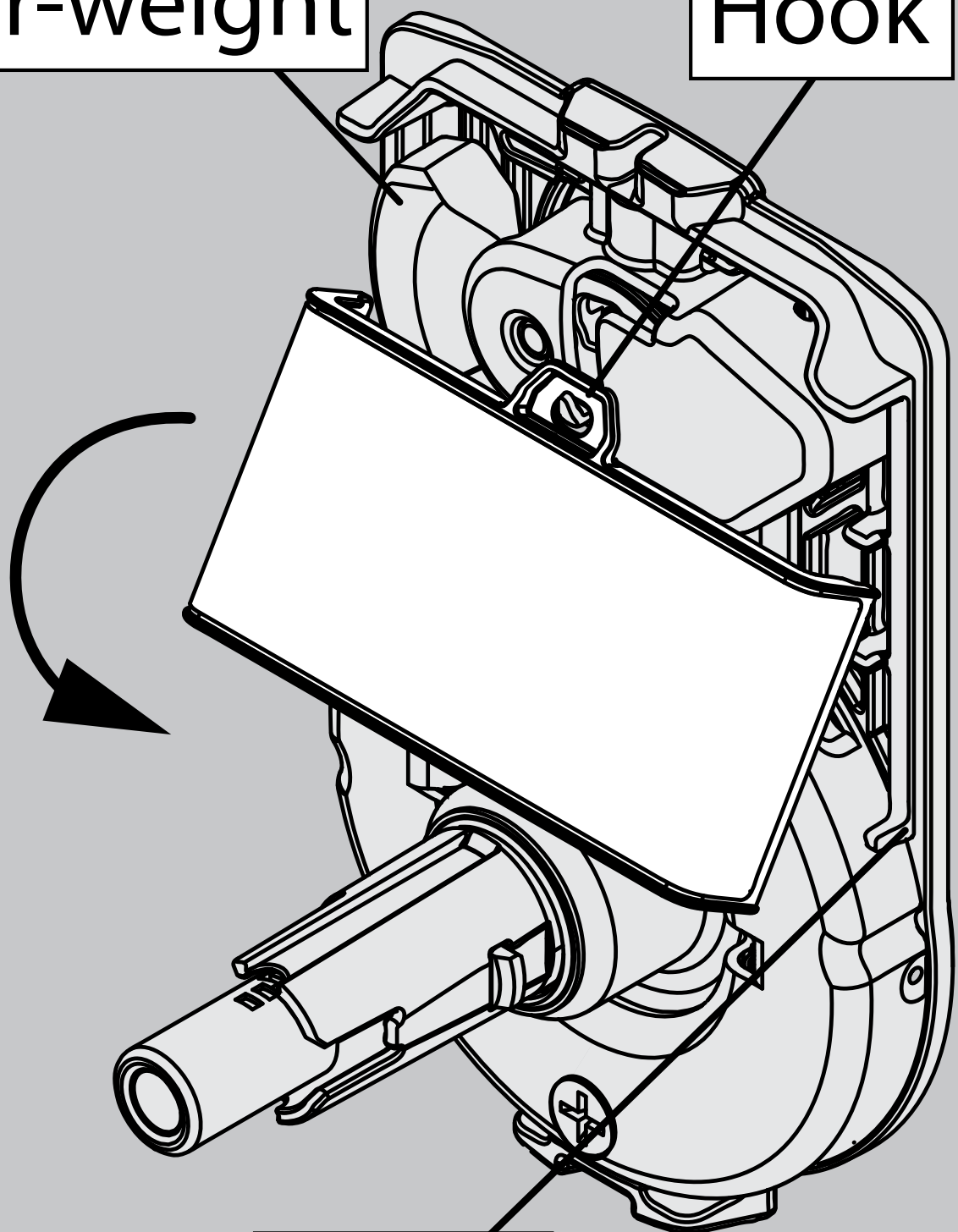

Ledge

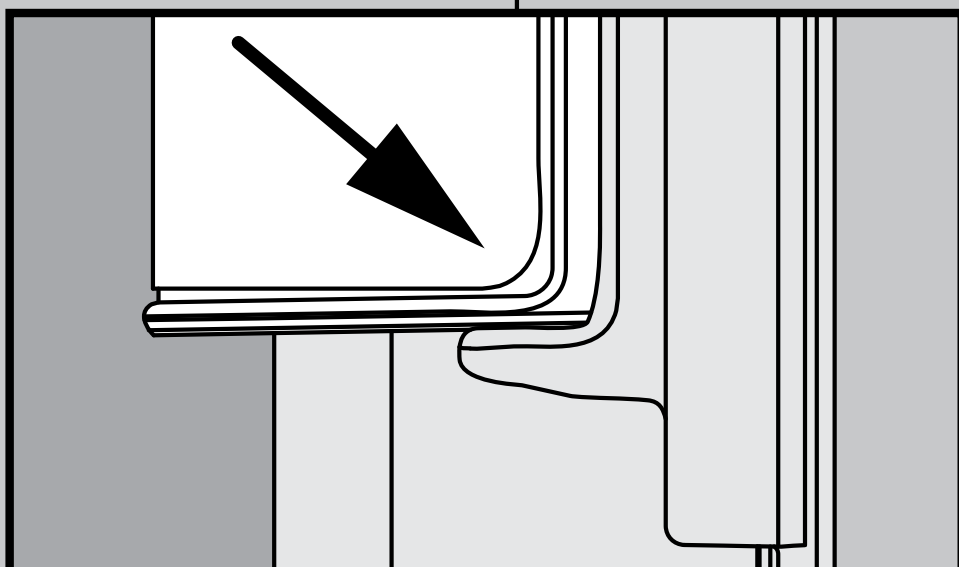

10 Install escutcheon (1 of 2)

Hook escutcheon tabs into baseplate notches.

Escutcheon tabs

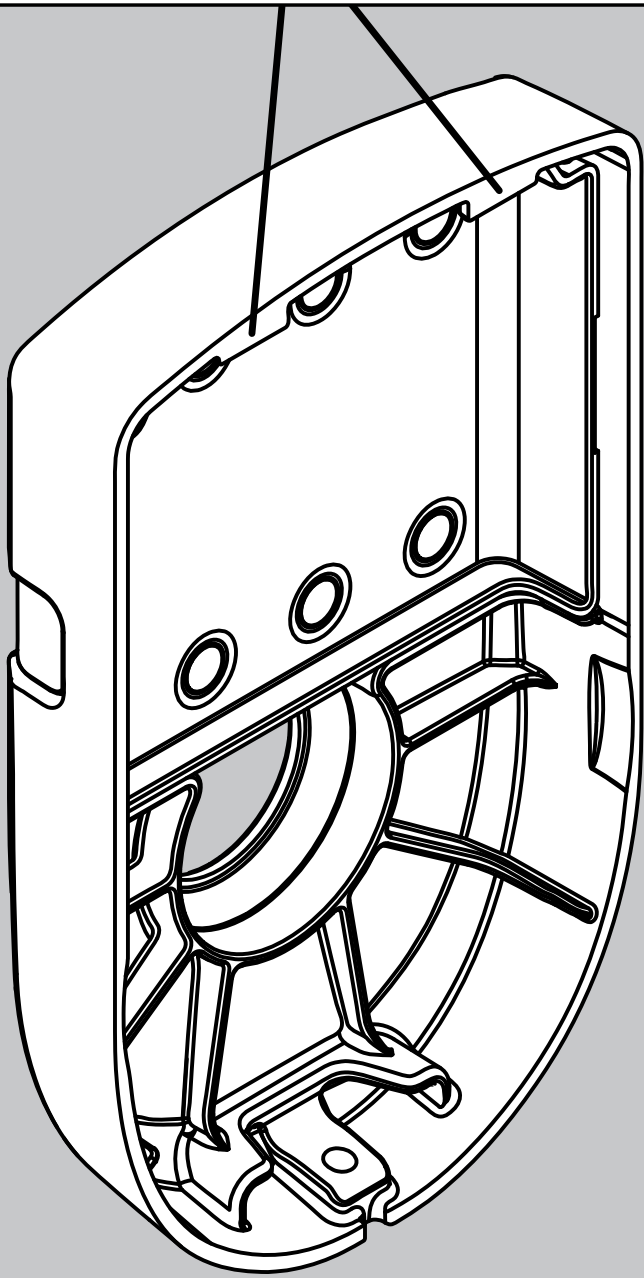

Baseplate notches

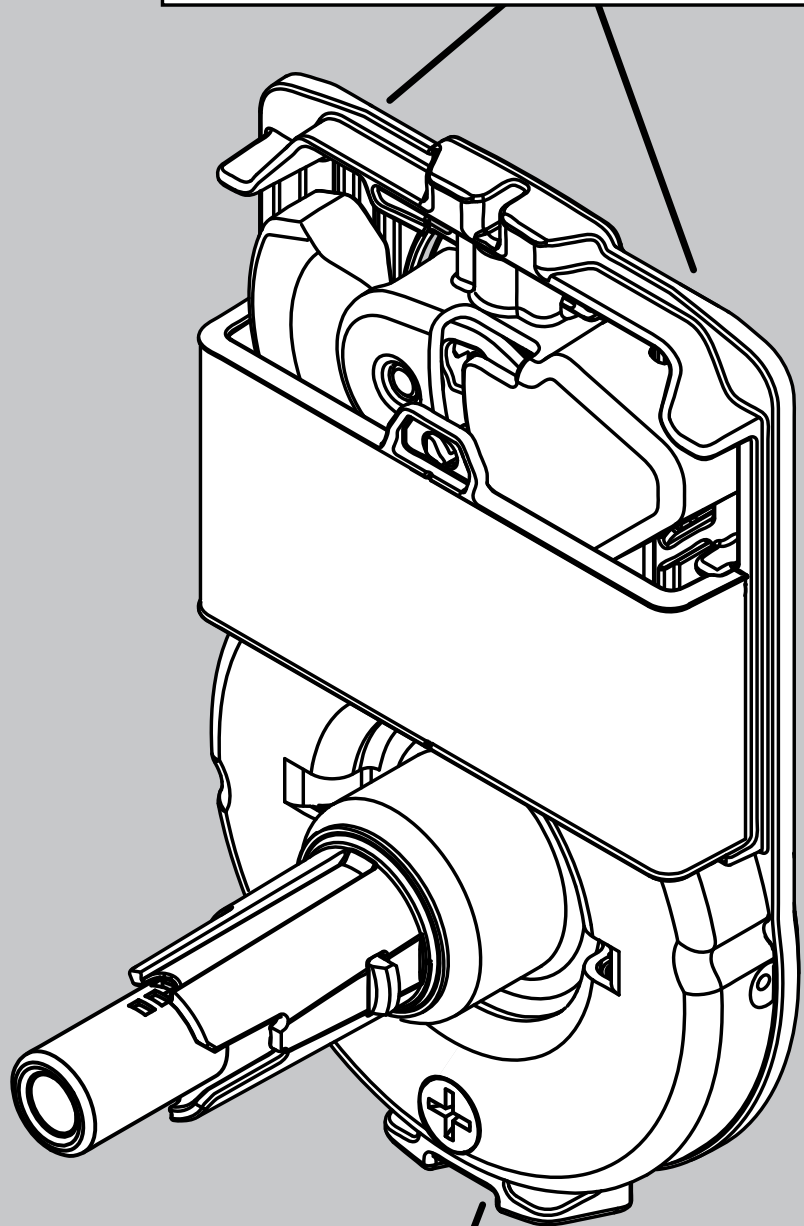

Baseplate slot

10 Install escutcheon (2 of 2)

Pivot escutcheon against door. Tighten one (1) set screw into baseplate slot with hex key.

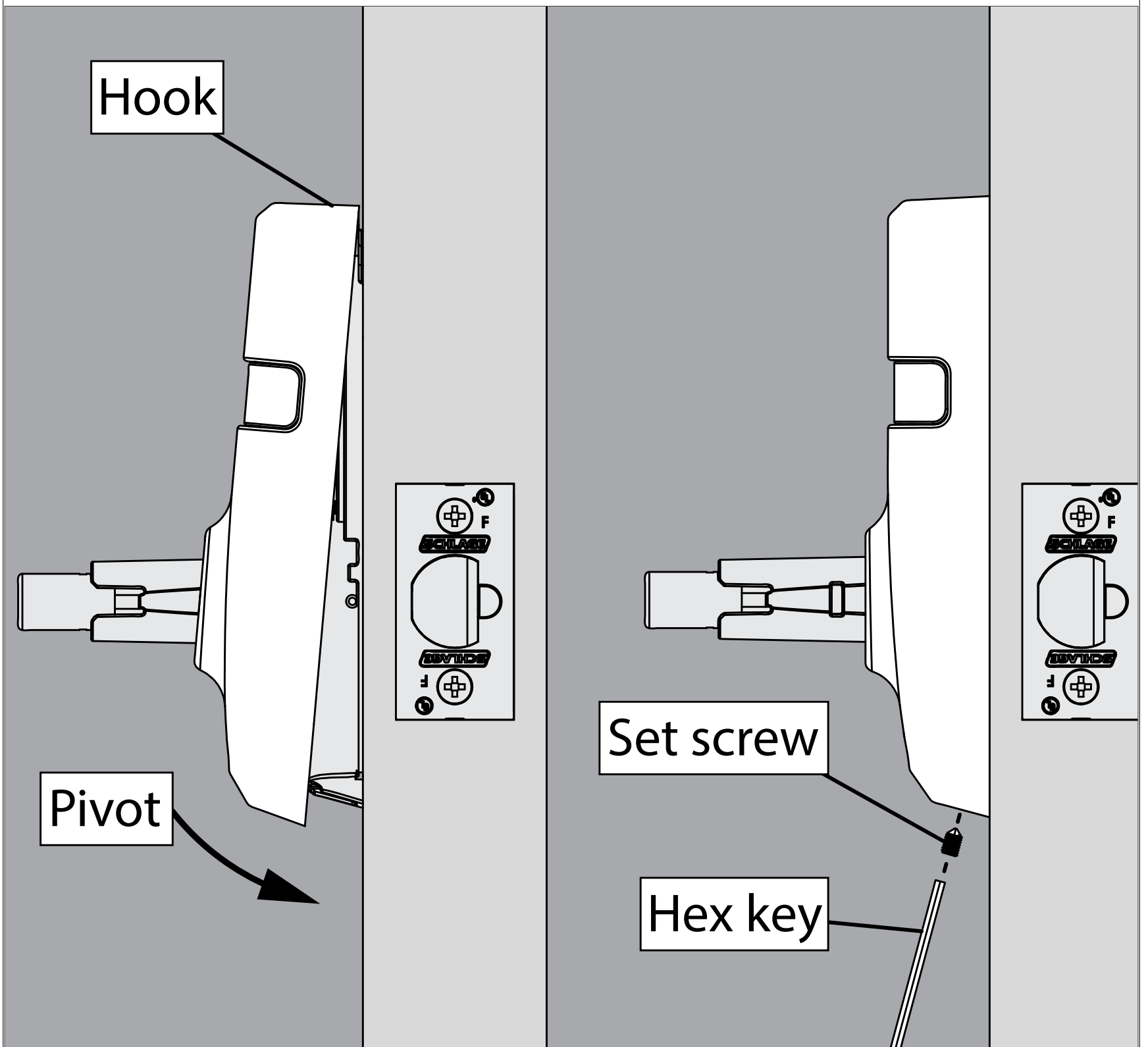

11 Install inside lever

Install inside lever. Push lever on until it clicks into place.

ⓘ Note: The interior lever has a smaller hole than the exterior lever.

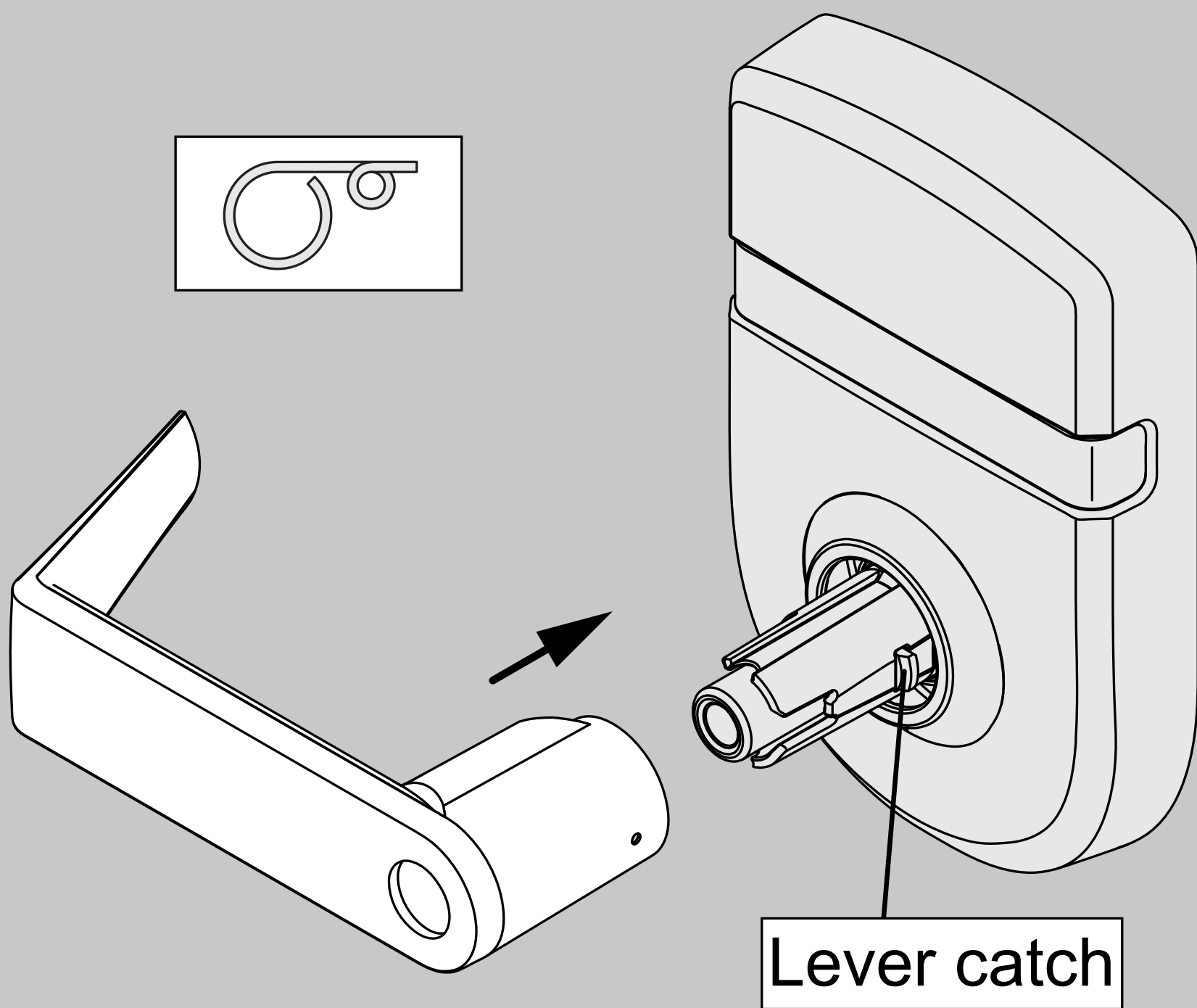

ⓘ Note: A pin wrench may be required to depress the lever catch if mechanism is extra tight.

12 Install strike

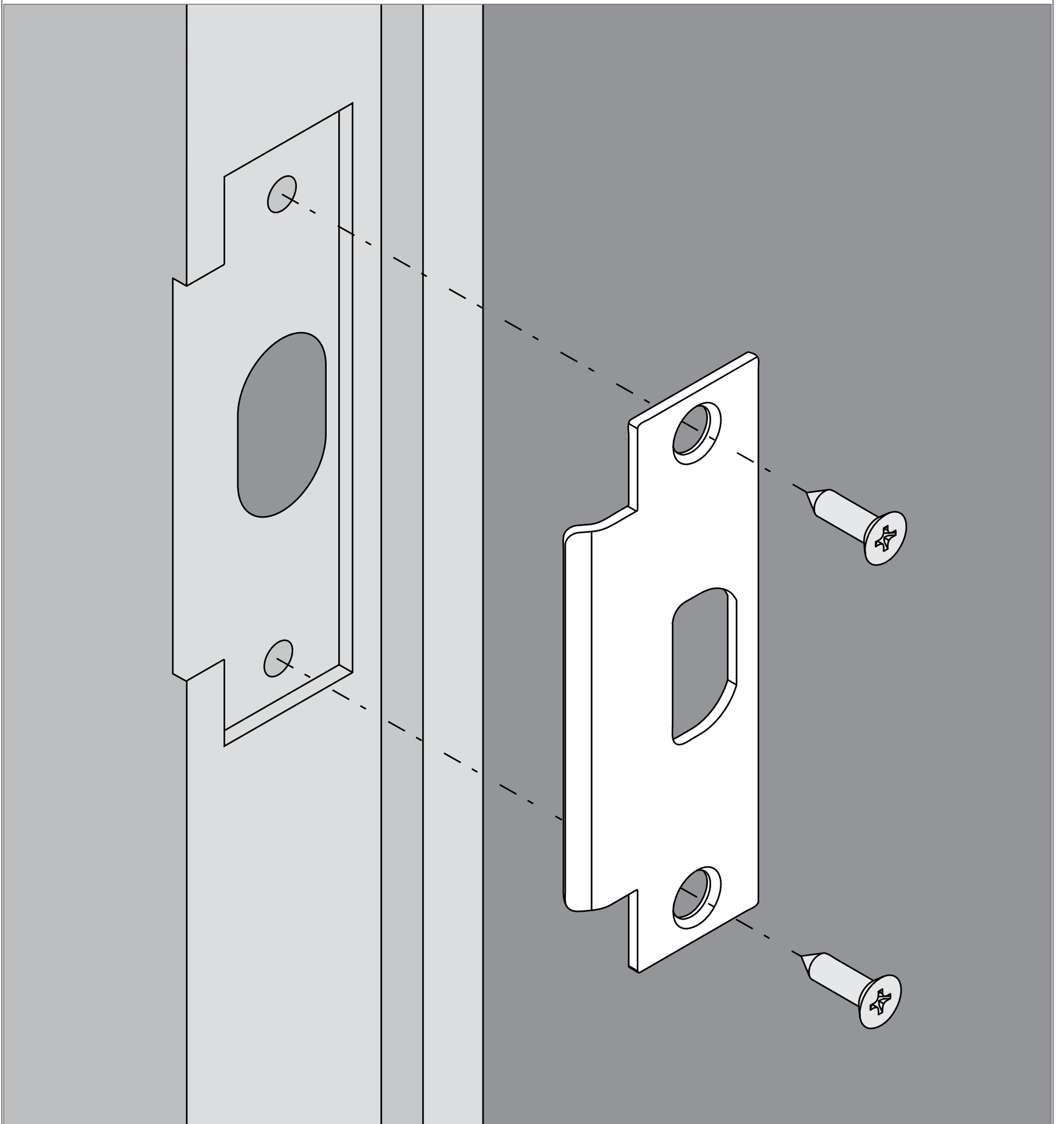

13 Complete

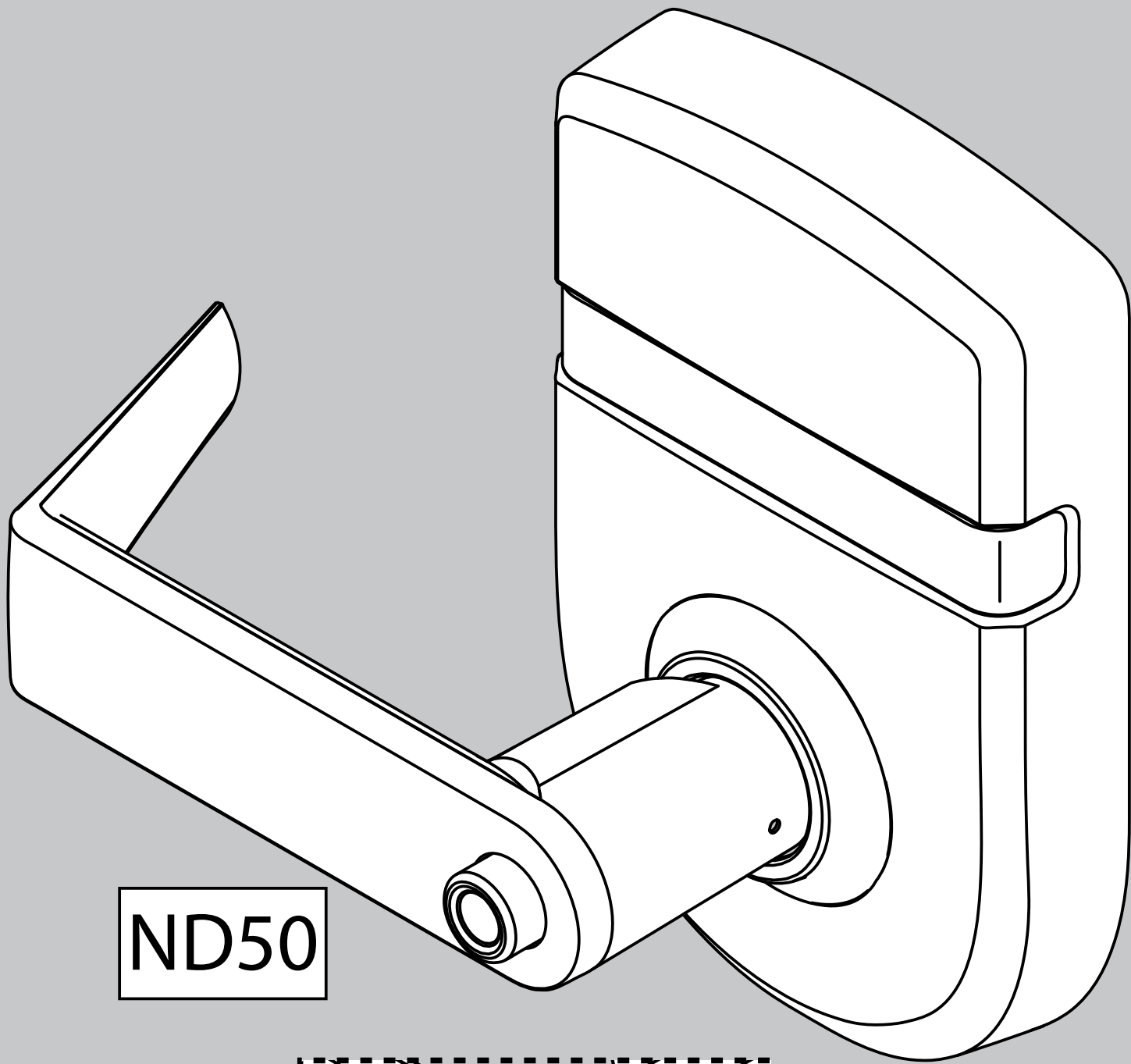

ND50

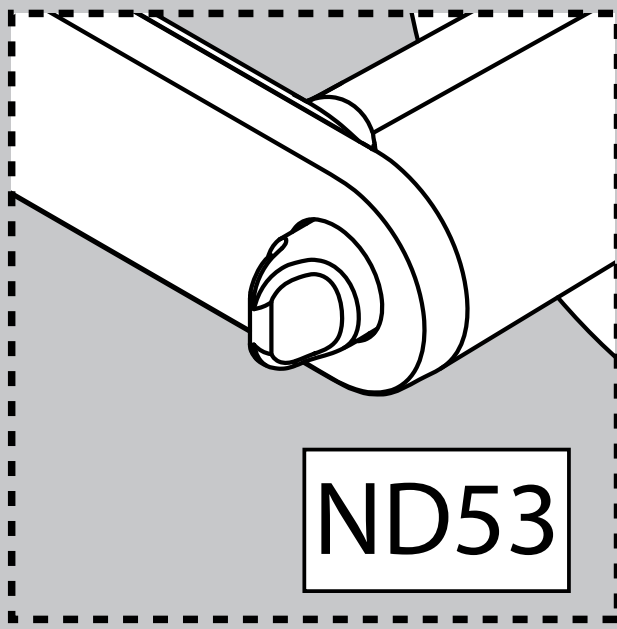

ND53

Continue to next page to check lock function.

Checking lock function (ND50)

1. Push the inside button to lock the outside lever.

Check that the outside lever is locked and the indicator sign raises to read “**Locked**”.

2. Rotate the inside lever to release the button and unlock the outside lever.

Check that the outside lever is unlocked and the indicator sign lowers to read “**Unlocked**”.

3. Push the inside button to relock the outside lever.

Check that the outside lever is locked and that the indicator sign raises to read “**Locked**”.

4. Insert and rotate the key either direction in the outside lever to release the inside button.

Check that the outside lever is unlocked and the indicator sign lowers to read “**Unlocked**”.

5. The inside lever should always be unlocked and rotate freely.

Checking lock function (ND53)

1. Push the inside button to lock the outside lever.

Check that the outside lever is locked and the indicator sign raises to read “**Locked**”.
2. Rotate the inside lever to release the button and unlock the outside lever.

Check that the outside lever is unlocked and the indicator sign lowers to read “**Unlocked**”.
3. Push the inside push button to relock the outside lever. Rotate the inside button 90 degrees **clockwise**.

Check that the outside lever is locked and that the indicator sign raises to read “**Locked**”.
4. Insert and rotate the key either direction in the outside lever to retract the latch.

Check that the outside lever is still locked and the indicator sign remains in the “**Locked**” position.
5. Rotate the inside button back 90 degrees **counterclockwise**. Insert and rotate the key in the outside lever to release the inside button.

Check that the outside lever is unlocked and the indicator sign lowers to read “**Unlocked**”.
6. The inside lever should always be unlocked and rotate freely.

Chassis Handing (1 of 3)

ⓘ **Complete this step only if the slide opening does not align with the latch.**

A Use Phillips screwdriver to loosen and remove screw.

B Separate the indicator assembly from the lock chassis.

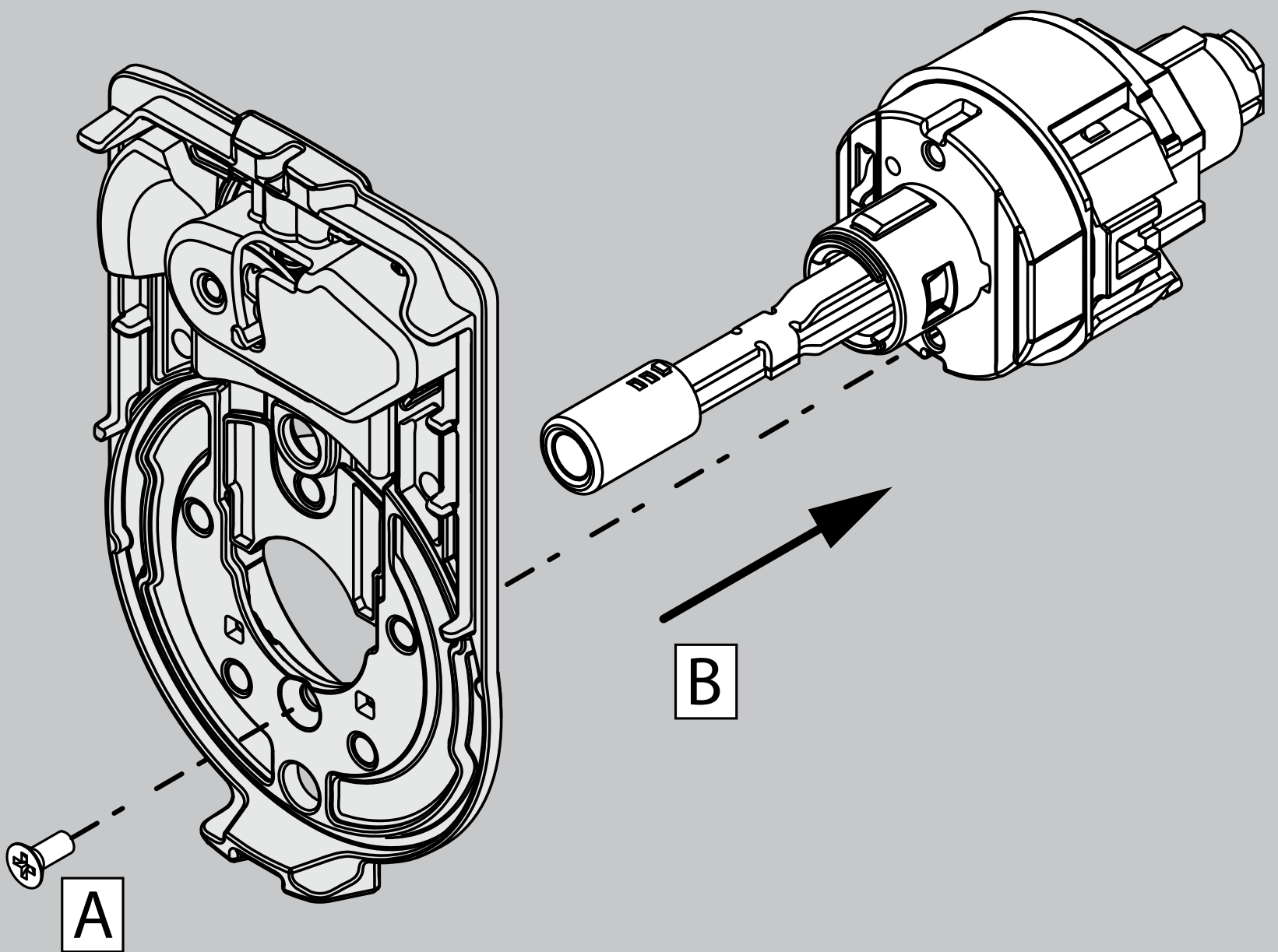

Chassis Handing (2 of 3)

C Rotate Chassis 180° to align slide opening towards latch.

D Rotate both cams downwards. Chassis must be unlocked in order to rotate upper cam.

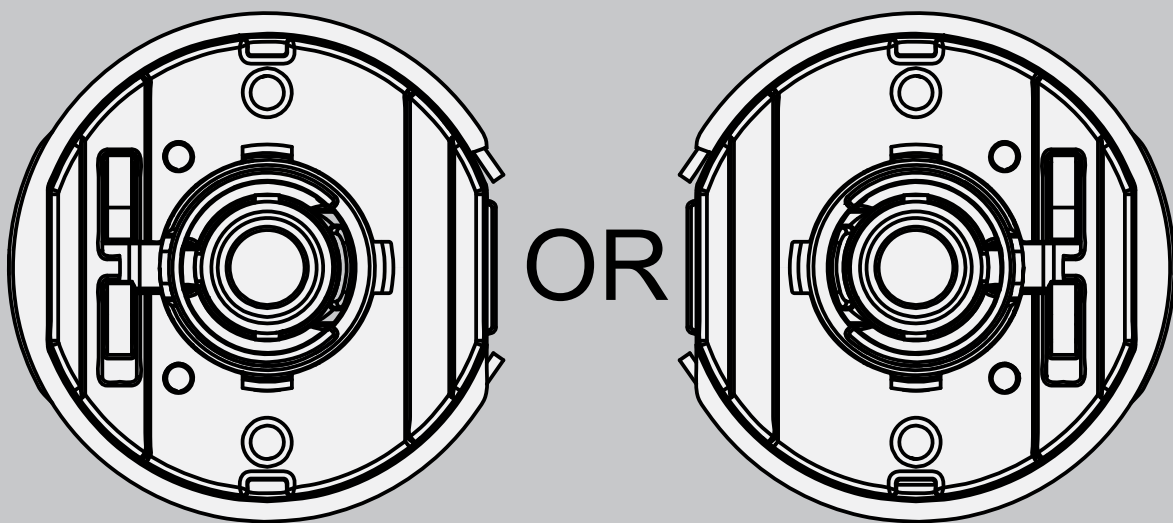
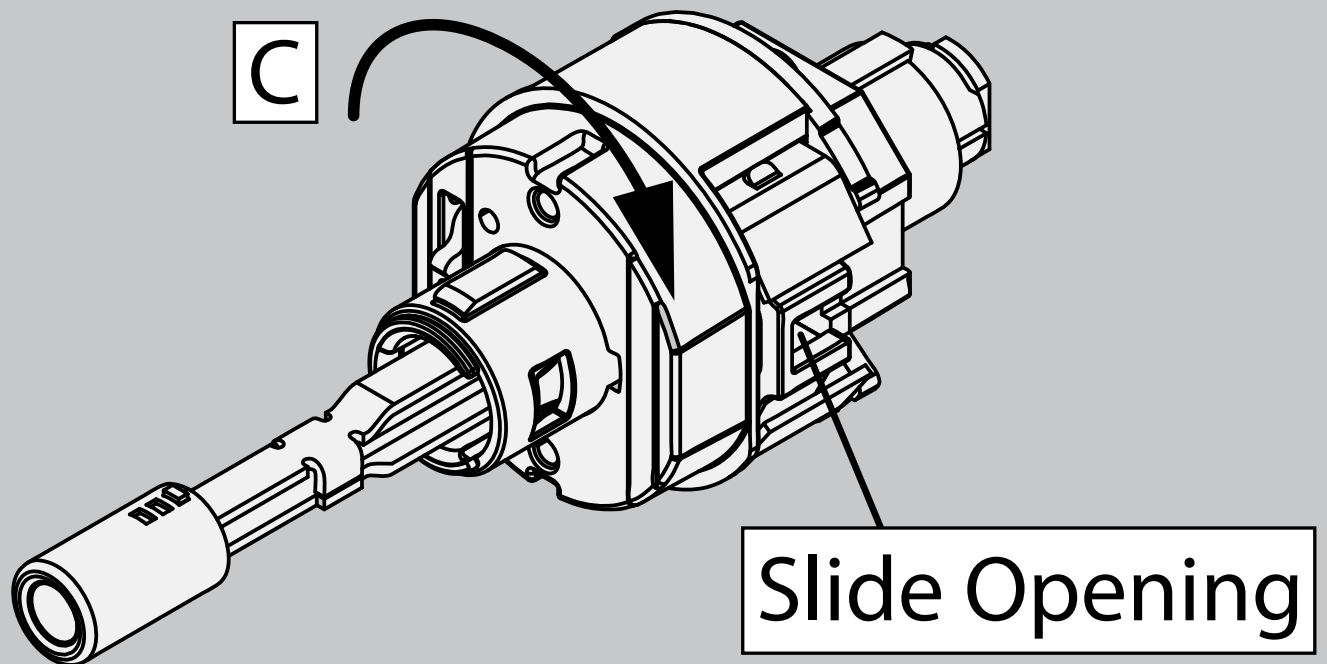

The cams **MUST** be rotated down.

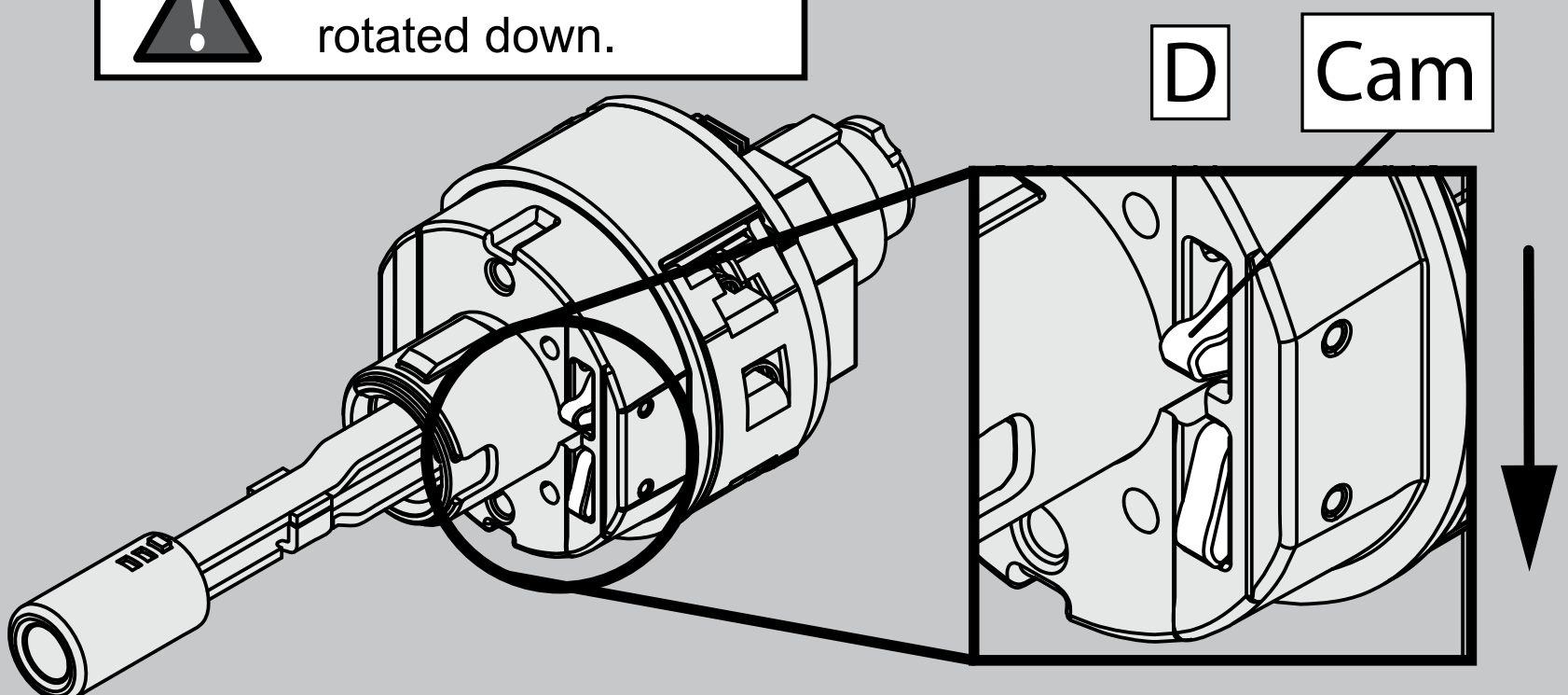

Chassis Handing (3 of 3)

E Reassemble chassis and indicator assembly. Tighten one (1) screw.

F Confirm that the upper cam is engaged with the slider and lower cam is engaged in rectangular hole.

