

CONVERSION INSTRUCTIONS

1. Remove Device, Trim & Mortise Lock from door & Strike from frame.
2. Convert trim (if required).
 - A. EO,DT,NL & K trim can be used without modification.
 - B. IF 880 TP-M trim is used, see Fig.2.
 - C. If 7623 TP-M trim is used, see Fig.3.
 - D. If 373-L Control is used, see Fig.4.
3. For Mortise Lock conversion see opposite side of sheet.
4. For 88 Mortise Device Lift Finger adjustment, see Fig.1. For 44 Mortise device, no adjustment required.
5. Install Mortise Lock, device, trim, strike & cylinder (if required).

88 MORTISE DEVICE ADJUSTMENT FOR 7500 MORTISE LOCK

Adjust Lift Finger for full 3/4" latch bolt extension and full retraction by lever arm.

A. To raise Lift Finger, tighten Set Screw. To lower Lift Finger, loosen Set Screw.

8834 Devices will require that the Lift Finger be lowered so that when the Lever Arm is fully depressed, the Latch Bolt will be fully retracted. The Lock Body must not stop the Lever Arm before it is fully depressed.

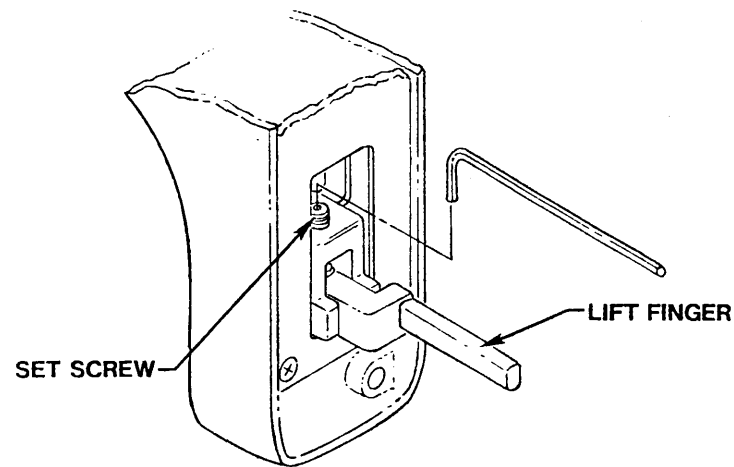

FIG.1

REPLACE 880 TP-M THUMBPIECE FOR 7500 MORTISE LOCK

1. Remove existing Thumbpiece Axle (2) and Thumbpiece (4) from Bracket (3).
- NOTE: Existing thumbpiece axle is a rivet and riveted end must be drilled out or ground away to remove axle.
2. Install new Thumbpiece (4) into Bracket (3).
 3. Install new Thumbpiece Axle (2) thru Bracket and Thumbpiece.
 4. Install Retaining Ring (1) on end of Thumbpiece Axle (2).

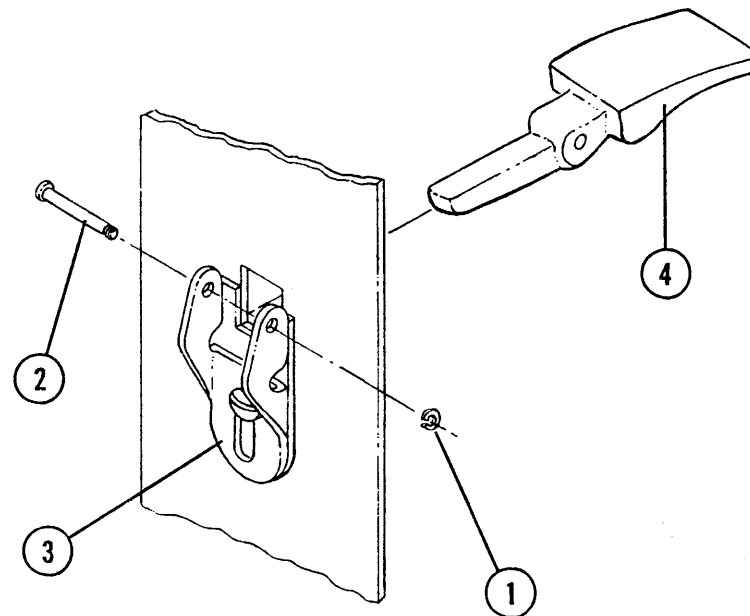

FIG.2

VON DUPRIN

REPLACE 7623 TP-M THUMBPIECE FOR 7500 MORTISE LOCK

1. Drive Thumbpiece Axle (1) out of Pull Grip (2) and remove existing Thumbpiece (3).
2. Install new Thumbpiece (3).
3. Drive Thumbpiece Axle (1) into Pull Grip (2) and Thumbpiece (3).

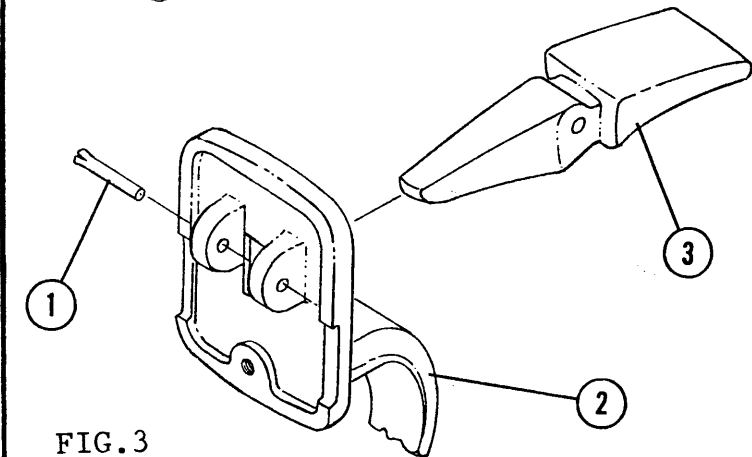

FIG.3

CONVERT 373-L CONTROLS FOR 7500 MORTISE LOCK

1. Install Lever Stop Block (1), #6 Dished Lock Washer (2) and #6-32 x 1/4 PPHMS (3).

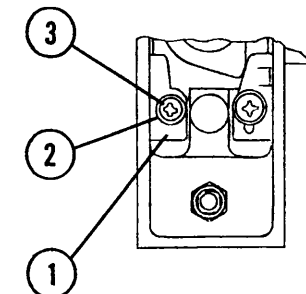
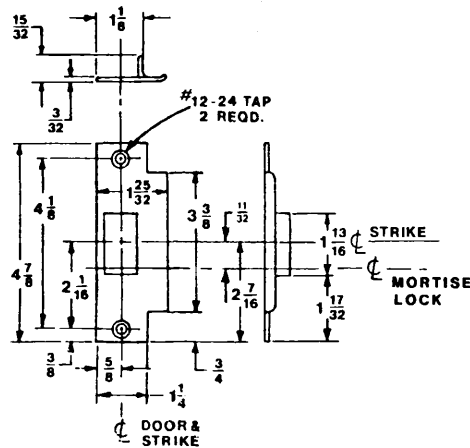

FIG. 4

DESCRIPTION: INSTRUCTIONS FOR CONVERTING
34 OR 58 MORTISE LOCK TO 7500 MORTISE
LOCK ON 88 & 44 MORTISE DEVICES

IR Ingersoll Rand
Security Technologies

DIRECTION NUMBER: **941957-00(3)** DATE **3-31-92**



575 MORTISE STRIKE
 DIRECT REPLACEMENT FOR 582 STRIKE
 SINGLE DOOR APPLICATION
 LHR SHOWN
 (ACTUAL STRIKE DIMENSIONS)

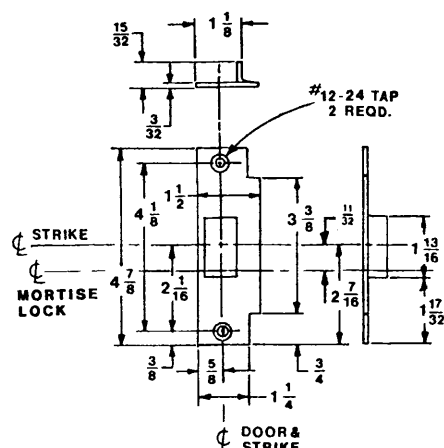

575-2 MORTISE STRIKE
 DIRECT REPLACEMENT FOR 582-2 STRIKE
 DOUBLE DOOR APPLICATION
 CLOSED BACK STRIKE
 LHR SHOWN
 (ACTUAL STRIKE DIMENSIONS)

HANDING MORTISE LOCK

NOTE: MORTISE LOCK IS SHIPPED HANDED FOR R.H.R. DOOR (SEE FIG. 3A) AND FOR EO, DT, AND NL APPLICATION.

3. TO CHECK DEAD LOCKING DEPRESS AUXILIARY BOLT ① FULLY & HOLD. ATTEMPT TO DEPRESS LATCH BOLT. ② LATCH BOLT SHOULD ONLY DEPRESS 1/8".

REVERSING PROCEDURE FOR L.H.R. DOOR (SEE FIG. 3B)

1. REMOVE TWO SCALP PLATE RETAINING SCREWS ① AND SCALP PLATE ② FROM LOCK.
2. REMOVE INSERT ③ FROM LOCK. ROTATE LATCH BOLT ④ 180°. REPLACE INSERT ③, SCALP PLATE ② AND TWO SCALP PLATE RETAINING SCREWS ①.

ADJUST FACE PLATE FOR DOOR BEVEL (SEE FIG. 3B)

1. LOOSEN TOP AND BOTTOM FACE PLATE RETAINING SCREWS ⑤. PIVOT FACE PLATE ⑥ TO MATCH BEVEL OF DOOR AND TIGHTEN TOP AND BOTTOM FACE PLATE RETAINING SCREWS ⑤.

ADJUST MORTISE LOCK FOR TRIM FUNCTION (SEE FIG. 3A & 3B)

1. FOR EO, DT, AND NL TRIM APPLICATIONS MORTISE LOCK REMAINS AS SHIPPED.
2. FOR TP, K AND LV TRIM APPLICATIONS, TURN SET SCREW ⑦ CLOCKWISE UNTIL IT SEATS AND REMOVE PAN HEAD MACHINE SCREW ⑧. (SEE LABELS ON MORTISE LOCK)

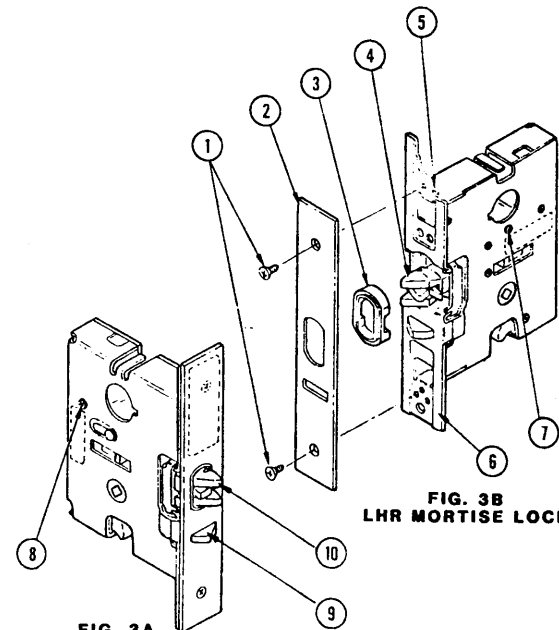
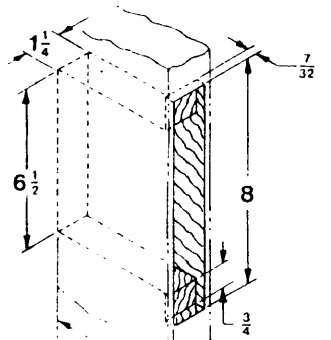

FIG. 3B
 LHR MORTISE LOCK

FIG. 3A
 RHR MORTISE LOCK



NOTE: WIRING TO SS7500 LOCK GOES THRU DOOR & NOT DEVICE

WOOD DOOR PREPARATION

NOTE: ADDITIONAL PREPARATION WILL BE REQUIRED FOR E-7500 LOCK ON WOOD DOOR. SEE DIRECTION SHEET NO. 41731.

7500 MORTISE LOCK
 (ACTUAL MORTISE LOCK DIMENSIONS)

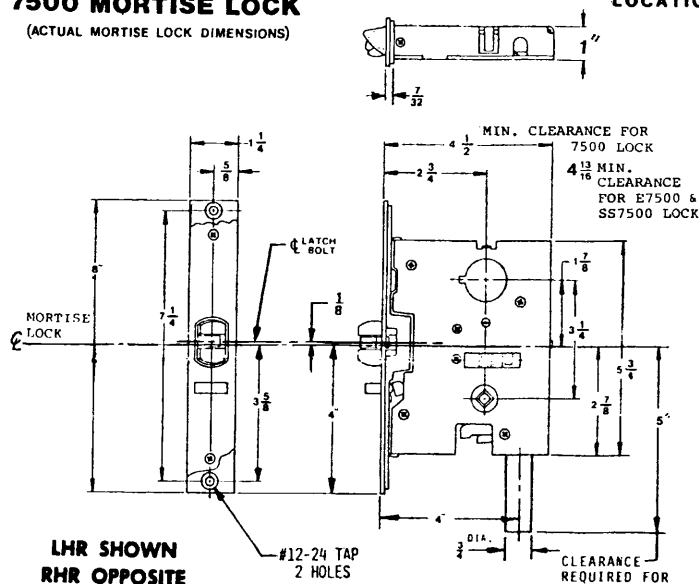

LHR SHOWN
 RHR OPPOSITE

NOTE: WIRING TO E7500 & SS7500 LOCKS GOES THRU DOOR & NOT DEVICE

NOTE: ADDITIONAL CLEARANCE ON INSIDE OF DOOR MAY BE REQUIRED BECAUSE OF LARGER 7500 LOCK HOUSING AND DIFFERENT SOLENOID LOCATION ON E-7500 LOCK

MORTISE CYLINDER INSTALLATION

NOTE: MAXIMUM MORTISE CYLINDER LENGTH IS 1 3/8" FOR 1 3/4" THICK DOOR, AND 1 1/2" FOR 2 1/4" THICK DOOR.

1. REMOVE TWO SCALP PLATE RETAINING SCREWS ① AND SCALP PLATE ② FROM LOCK.
2. BACK CYLINDER ANCHOR SCREW ③ OUT FAR ENOUGH TO CLEAR INSTALLATION OF MORTISE CYLINDER ④ BUT DO NOT REMOVE FROM THREADED BRACKET INSIDE MORTISE LOCK.
3. INSTALL MORTISE CYLINDER ④ AND TIGHTEN CYLINDER ANCHOR SCREW ③ INTO GROOVE ON SIDE OF MORTISE CYLINDER.
4. REPLACE SCALP PLATE ② AND TWO SCALP PLATE RETAINING SCREWS ①.

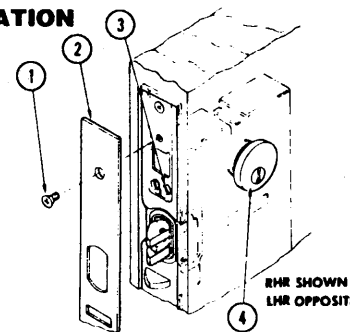

RHR SHOWN
 LHR OPPOSITE

E-7500 OR SS-7500 MORTISE LOCK WIRING DIAGRAM

NOTES:

1. All switches shown with the lock in the closed and locked position.
2. The Aux. Bolt Monitor will switch the Red wire to the Blue wire whenever the Aux. Bolt is not depressed or the latch bolt is not dead locked.
3. The Trim Monitor Switch will indicate the locked or unlocked condition of the outside trim. When the trim is electrically or mechanically unlocked the Violet wire is switched to the Gray wire. The monitoring of the trim and lock functions are the same for the Fail Secure and Fail Safe locks.
4. A continuous current electric hinge or equivalent is required to transfer the wiring from the door to the frame.
5. All wiring should be spliced with an approved insulated connector.
6. All unused wires should be cut and insulated.
7. Switch Contact Rating - one amp, 48VDC or VAC.

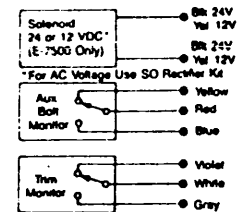

VON DUPRIN
 Part of worldwide Ingersoll-Rand