



941013-00

88

VON DUPRIN®

Lever Arm Axle

Installation Instructions

Directions

- 1 Assemble lever arm and case. See directions on device installation template.
- 2 Press male axle and female axle together (as shown) until they snap in place.
- 3 If removal is required, push axle separator into the female axle in direction shown. This will depress the end of the male axle and release both parts.

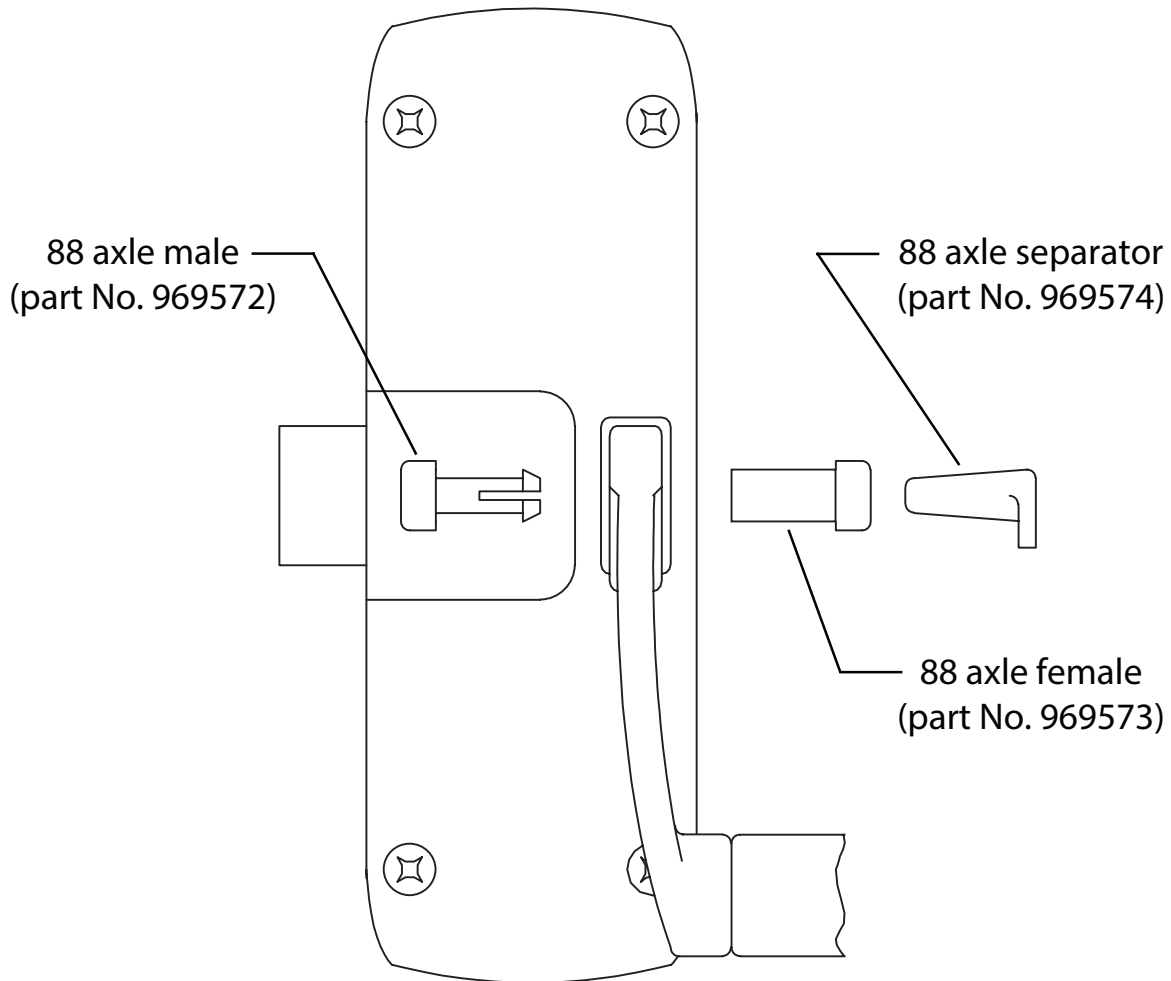

See master sheet no. 10001 for suggested reinforcing

Customer Service

1-877-671-7011 www.allegion.com/us



© Allegion 2014
Printed in U.S.A.
941013-00 Rev. 01/14-b